

D-1800-FT4
Shotblaster/Scarifier
Diamond Grinder/Polisher
Chassis Manual



3706 Mill Creek Drive NE
Comstock Park, MI 49321
VOICE: (616) 447-9076
FAX: (616) 447-9078
E-mail: info@bwmanufacturing.com
www.bwmanufacturing.com

D-1800 Serial # _____

Engine Serial # _____

Version 11/2019

Part# H-130

INDEX

INTRODUCTON.....	Page 3
TERMS & CONDITIONS OF SALE.....	Page 4 & 5
HAZ-MAT SAFETY WARNING.....	Page 6
WARRANTY BREAKDOWN.....	Page 7
EQUIPMENT SPECIFICATIONS.....	Page 8
EMISSION SPECIFICATIONS.....	Page 9
SERVICE INTERVAL CHART.....	Page 10
CHASSIS SERVICE & OPERATION....	Page 11 - 18
CHASSIS PARTS:	
BODY GROUP.....	Page 19-29
ENGINE GROUP.....	Page 30-33
HYDRAULIC GROUP....	Page 34-43
ELECTRICAL GROUP...	Page 44-46
AIR GROUP.....	Page 47-50

INTRODUCTION

FORWARD

WARNING READ THIS MANUAL CAREFULLY PRIOR TO OPERATING THE EQUIPMENT IN ORDER TO UNDERSTAND HOW TO OPERATE AND SERVICE THE EQUIPMENT CORRECTLY. FAILURE TO PROPERLY REVIEW THIS MANUAL COULD RESULT IN PERSONAL INJURY OR EQUIPMENT DAMAGE.

This manual should be considered a permanent part of the equipment and should remain with the equipment at all times. Please note the following:

Measurements in this manual are given in metric and standard U.S. measurement equivalents.

Use only correct replacement parts and fasteners. Fasteners may require specific tools.

Right and left hand sides are determined by facing forward while sitting in the seat behind the steering wheel.

THIRD-PARTY MANUFACTURER INFORMATION

This equipment contains an engine manufactured by a third-party manufacturer. This engine may be covered by the manufacturer's standard factory warranty and the manufacturer may require that all repairs and/or service be completed pursuant to its warranty terms and conditions. Please refer to the product manual and Warranty Breakdown for additional information on this warranty and any registration requirements.

TERMS AND CONDITIONS OF SALE

1. **Parties.** "Seller" means **BW Manufacturing, Inc.** "Buyer" means any entity or individual purchasing goods from Seller.
2. **Terms and Conditions of Sale.** These Terms and Conditions of Sale define the relationship of Buyer and Seller and apply to all sales of equipment (including, but not limited to Shotblasters, Scarifiers, Diamond Grinders/Polishers, Concrete Dust Collection Systems, and Trailers), components incorporated into equipment, parts, supplies, materials or other personal property (individually and collectively, "Equipment") by Seller to Buyer. Buyer acknowledges and agrees that these Terms and Conditions of Sale are incorporated in, and are a part of, any contract of sale and each quotation, purchase order, invoice, and any other document relating to the sale of Equipment by Seller to Buyer (these documents are collectively referred to as the "Agreement").
3. **Quotation Expiration.** Written quotations signed by Seller are valid for a period of 30 days unless otherwise noted by Seller.
4. **Pricing.** Prices for Equipment and other related information shown in any Seller product publication, including but not limited to catalogs, brochures, and websites, are subject to change without notice. Prices do not include related freight charges, use tax, sales tax, excise tax, value-added tax, or similar taxes, or charges of any nature whatsoever imposed by any governmental authority unless otherwise expressly noted by Seller.
5. **Taxes.** Prices quoted do not include (and Buyer shall pay) all taxes and fees of any kind that may be levied or imposed on either party by federal, state, municipal, or other governmental authorities in connection with the sale or delivery of the Equipment by Seller.
6. **Terms of Payment.** Unless Buyer has obtained credit approval from Seller, payment is due and payable to Seller in cash on completion of Seller's delivery obligation (COD). For Buyers with credit approval, any amounts due by Buyer to Seller that are unpaid on or after 30 days of Seller's invoice will bear interest at the simple interest rate of 2 percent (2%) per month or the maximum rate permitted by law, whichever is less. The accrual or payment of any interest as provided above will not constitute a waiver by Seller of any rights and remedies in connection with a default by Buyer. Buyer will pay all court costs, attorney fees, and other costs incurred by Seller in collecting past-due amounts, including interest. If shipment or delivery of Equipment is delayed by or at the request of Buyer, payment will remain due in full on the original delivery date for Buyers without credit approval or 30 days from the date of Seller's invoice for Buyers with credit approval. In either such event, Seller may impose, and Buyer shall pay, storage charges and other incidental expenses incurred by Seller as a result of the delay in addition to any interest on late payments as described above.
7. **Security Interest.** As security for payment of all amounts due to Seller, Buyer grants to Seller a security interest in all Equipment sold by Seller to Buyer, and Seller will have all rights of a secured party under the Uniform Commercial Code with respect to the Equipment. Buyer appoints Seller as its attorney-in-fact with authority, at Seller's option, to take actions as Seller deems reasonable in the circumstance to perfect the above security interest in any one or more jurisdictions, and Buyer shall pay all applicable filing fees.
8. **Limited Express Warranty.** For a period of ninety (90) days from the completion of Seller's delivery obligation under this Agreement, Seller warrants that a limited selection of components manufactured by Seller and incorporated into the Equipment will be free of defects in material and workmanship. A complete list of components covered under this warranty ("Warranty Breakdown") and is incorporated in its entirety into this Agreement. In the event Buyer has a claim related to the components covered under this warranty, Buyer shall be bound by the then-current Warranty Breakdown. Buyer's sole remedy for breach of this warranty is limited to repair and replacement, within the warranty period, of defective components manufactured by Seller and covered under this warranty pursuant to the Warranty Breakdown. Buyer is responsible for all shipping costs arising out of any warranty service provided by Seller. SELLER EXPRESSLY DISCLAIMS AND EXCLUDES ALL OTHER WARRANTIES, EXPRESS OR IMPLIED, WITH REGARDS TO THE EQUIPMENT AND/OR COMPONENTS MANUFACTURED BY SELLER AND INCORPORATED INTO THE EQUIPMENT, WHICH ARE NOT INCLUDED IN THE ABOVE REFERENCED WARRANTY, INCLUDING THE WARRANTIES OF MERCHANTABILITY AND FITNESS FOR A PARTICULAR PURPOSE. BUYER ASSUMES FULL RESPONSIBILITY THAT THE EQUIPMENT PURCHASED UNDER THE AGREEMENT MEETS THE SPECIFICATIONS AND/OR INTENDED USE OF BUYER, AND SELLER MAKES NO REPRESENTATION WITH RESPECT THERETO.
9. **Disclaimer of Third-Party Component Warranties.** THE SOLE REMEDY AVAILABLE TO BUYER WITH RESPECT TO DEFECTS IN THE COMPONENTS MANUFACTURED BY THIRD PARTIES WILL BE AGAINST THE THIRD PARTY MANUFACTURER UNDER ANY APPLICABLE MANUFACTURER'S WARRANTY TO THE EXTENT AVAILABLE TO BUYER. WITH REGARDS TO COMPONENTS MANUFACTURED BY THIRD PARTIES AND INCORPORATED INTO THE EQUIPMENT, SELLER MAKES NO WARRANTY, EXPRESS OR IMPLIED, RELATING TO THE COMPONENTS, WHETHER BASED ON BREACH OF WARRANTY OR CONTRACT, NEGLIGENCE, STRICT LIABILITY OR OTHERWISE, INCLUDING WITHOUT LIMITATION ANY IMPLIED WARRANTIES OF MERCHANTABILITY OR FITNESS FOR A PARTICULAR PURPOSE.

10. **No Consequential Damages.** IN NO EVENT WILL SELLER BE LIABLE OR RESPONSIBLE FOR ANY SPECIAL, INCIDENTAL, CONSEQUENTIAL, EXEMPLARY, OR PUNITIVE DAMAGES, OR FOR EXPENSE OCCASIONED BY THE USE OF DEFECTIVE EQUIPMENT.

11. **Delivery.** Any delivery dates or other schedule of performance by Seller are approximations, and the sole obligation of Seller with respect to the schedule of delivery or performance will be to use commercially reasonable efforts to deliver the Equipment, or otherwise to perform, consistent with the reasonable demands of its business. In any event, Seller will have no liability to Buyer or any other person for delays in performance due to strikes or labor disputes of any type; accidents, fire, floods, acts of God, or actions by governmental authorities; acts, omissions, or delays of Buyer or any other third party; shortages of labor; or without limitation of the above, for any causes reasonably beyond the control of Seller.

12. **Title and Risk of Loss.** Title to and risk of loss to the Equipment will pass to Buyer on delivery by Seller F.O.B. Seller's place of business, located at 3706 Mill Creek Dr. NE, Comstock Park, Michigan, 49321.

13. **Inspection and Acceptance.** Buyer will have two (2) days from the date of delivery to inspect the Equipment for defects and nonconformance and to notify Seller, in writing, of any defects, nonconformance, or rejection of the Equipment. After this period, Buyer will be deemed to have irrevocably accepted the Equipment. After acceptance, Buyer will have no right to reject the Equipment for any reason or to revoke acceptance. Seller is not responsible for damage to the Equipment arising out of the shipment of the Equipment to Buyer. Claims for damage due to shipping must be made by Buyer to the freight carrier.

14. **Return of Equipment.** All returns will be pursuant to Seller's instructions. Buyer must contact Seller for a Return Material Authorization (RMA) before returning any Equipment. All returns must reference the RMA number along with the original invoice number and the reason for return.

15. **Cancellation or Termination.** In the event of cancellation of the Agreement by Buyer, or in the event of default under the Agreement by Buyer that is not cured within 30 days after notice by Seller, Buyer will pay to Seller on demand all direct and indirect costs (including, without limitation, all applicable restocking or cancellation charges, including reimbursement for direct costs assessed by the manufacturer) incurred directly or indirectly by Seller in connection with the Agreement, all as reasonably determined by Seller, plus any lost profit. In no event, however, will any amount payable by Buyer under the Agreement exceed the total price payable by Buyer for the Equipment.

16. **Modifications and Waiver—Entire Agreement.** The Agreement contains the entire agreement between Seller and Buyer and can be modified or rescinded only by a writing signed by both parties. If any term of the Agreement is held invalid or unenforceable, all other terms of the Agreement shall remain in effect. Any document submitted by Buyer to Seller confirming its intention to purchase Equipment described in the Agreement will be deemed to constitute a confirmation and acceptance of the Agreement, even if the document states terms in addition to or different from those in the Agreement. All agreements between Seller and Buyer will be solely under the terms and conditions of the Agreement and Seller objects to any and all additional or different terms contained in any document submitted to Seller by Buyer. Any execution by Seller of any other document submitted by Buyer in connection with the purchase of Equipment does not constitute acceptance of or agreement to any terms and conditions in addition to or different from those contained in the Agreement, but will constitute only acknowledgment of receipt of the document. In addition, Buyer's acceptance of these terms shall be conclusively presumed by Buyer's (i) acceptance of delivery of or (ii) payment for Equipment covered under the Agreement.

17. **Compliance with Laws.** Buyer will be responsible for compliance with any and all federal, state, or local laws or regulations respecting safety or respecting use of the Equipment and shall indemnify and hold Seller harmless from and against any and all claims of violations of laws or regulations or other claims of personal injury or property damage directly or indirectly related to the installation, maintenance, or operation of the Equipment.

18. **Export Control.** Equipment supplied by Seller may be subject to various export laws and regulations. It is the responsibility of the exporter and Buyer to comply with all laws and regulations. If any required export authorization is denied, Seller will be relieved of any further obligation related to the sale and delivery of the Equipment.

19. **Governing Law and Venue.** This Agreement will be governed by and construed in accordance with the laws of the State of Michigan. Buyer submits to personal jurisdiction in Michigan. Seller and Buyer agree that any action arising out of the sale of goods or services in accordance with this document will be brought, heard, and decided in a court located in Kent County, Michigan and that this venue is convenient. .

20. **Authority.** Each signatory represents that it has all requisite authority to execute the Agreement on behalf of its principal and that the Agreement is fully enforceable against the principal in accordance with its terms.

B W MANUFACTURING, INC.

GENERAL SAFETY & HAZARDOUS MATERIALS WARNING

WARNING SURFACE PREPARATION EQUIPMENT CAN BE DANGEROUS IF NOT OPERATED PROPERLY. THE OPERATOR IS RESPONSIBLE FOR THE SAFE OPERATION OF THIS EQUIPMENT. The operator must carefully read and follow any warnings or safety instructions provided with the equipment prior to operating the equipment. Do not remove any safety devices or warnings on the equipment.

WARNING FLOOR AND/OR DECK SURFACES MAY BE COATED WITH OR CONTAMINATED BY HAZARDOUS MATERIALS. Typical examples of hazardous materials include (i) tile mastic (likely to contain *asbestos*); (ii) stained areas near electrical equipment (potentially containing *PCBS*); (iii) paint (potentially containing *lead*); (iv) stained floor areas in chemical or other industrial facilities (potentially containing toxic *pesticides*, *cleaning fluids*, *solvents*, or other *harmful chemicals*).

WARNING Preparation equipment is used to remove surface material from a variety of surfaces. The surface preparation process often generates large amounts of dust and other small particles, which are released into the air. WHEN A SURFACE CONTAINS HAZARDOUS MATERIALS, EXPOSURE TO THE DUST GENERATED BY THE PREPARATION EQUIPMENT MAY POSE A HEALTH RISK. INSPECT ALL SURFACES FOR POSSIBLE CONTAMINATES PRIOR TO USING PREPARATION EQUIPMENT AND CONSULT HAZARDOUS MATERIAL EXPERTS AND GOVERNMENT AUTHORITIES BEFORE OPERATING PREPARATION EQUIPMENT ON SURFACES SUSPECTED OF CONTAINING HAZARDOUS MATERIALS.

WARNING BW MANUFACTURING, INC. IN NO WAY REPRESENTS THAT ITS PREPARATION EQUIPMENT IS SUITABLE OR APPROVED FOR REMOVING HAZARDOUS MATERIALS FROM CONTAMINATED SURFACES. DO NOT ATTEMPT TO USE ANY PREPARATION EQUIPMENT MANUFACTURED BY BW MANUFACTURING, INC. ON ANY CONTAMINATED SURFACE. It is the responsibility of the preparation equipment operator and/or the contractor using the preparation equipment to inspect the proposed worksite for contaminants and obtain approval from contamination experts and/or government authorities before using BW Manufacturing, Inc. preparation equipment. It is also the responsibility of any contractor using preparation equipment to inform its employees or subcontractors of all potential health risks associated with operating preparation equipment and to ensure its employees or subcontractors are protected from exposure to harmful materials.

BW MANUFACTURING, INC. IS NOT RESPONSIBLE FOR ANY INJURY, ILLNESS, DEATH, OR PROPERTY DAMAGE THAT MAY RESULT FROM IMPROPER USE OF ITS PREPARATION EQUIPMENT OR OTHER PRODUCTS

WARRANTY BREAKDOWN

Item	NONE	90 DAYS	1YEAR / 500 HR	2 YEARS / 2000HR	WARRANTED BY:
Chassis		O			B W Mfg., Inc.
Engine				O	John Deere
Clutch			O		Twin Disc
Compressor			O		John Deere
Hydraulics		O			B W Mfg., Inc.
Dust Filters	O				B W Mfg., Inc.
BH-18 Blast head		O			B W Mfg., Inc.
Blast paddles	O				B W Mfg., Inc.
SC-16 Scarifier head		O			B W Mfg., Inc.
Scarifier cage	O				B W Mfg., Inc.
Main Shaft	O				B W Mfg., Inc.
DG-50 Grinding		O			
Diamond Mount	O				
Diamond Cutters	O				

WARRANTED BY:	Company to Contact
John Deere	Superior Diesel
	1-800-521-0956
Twin Disc	Palmer Johnson Distributor's
	1-800-641-4334
	Warehouse
	630-250-0370
B W Mfg., Inc.	B W Manufacturing, Inc.
	Voice: 616-447-9076
	Fax: 616-447-9078
	E-mail: bwmfginc@aol.com
	Warranty does not include travel time

Maintenance Points and Intervals

Blast Head Blades	Every 40 hours or if trailing shot. The leading edge of the blade should not be excessively rounded over.	Gap between blades and the upper rear liner is about 3/16".	Replace blades as a full set if worn. Do not individually replace blades.
Dust Filters		Filter should be free of holes, damage or a thick coating of dust.	Replace 10129-B filters as needed. Wash 10129-H filters from the inside out with a low pressure hose and give ample time to dry. (overnight or a full day)
Belts	Every 40 hours.	All belts should be properly tensioned and free of damage.	Re-tension or replace belts as needed.
Grease Points	As indicated on the machine.		As indicated on the machine.
Motor	Refer to motor manual.		As indicated in motor manual.

D-1800-FT4

EQUIPMENT SPECIFICATIONS

	<u>Model</u>	<u>D-1800-FT4</u>
Engine	Manufacture	John Deere
	Model	PowerTech 4.5L Final Tier 4
	Type	Vertical, Water Cooled, 4 Stroke Turbo Diesel
	Number of Cylinders	4
	Bore & Stroke	4.19" x 5" (106mm x 127mm)
	Total Displacement	4.5L (276 cu. in.)
	Engine Gross Power	74hp (55kW)
	No Load Fast Idle	2500 RPM
	Battery	1 - 12 Volt Deep Cycle Marine (800 CCA)
Capacities	Fuel Type	Diesel Fuel No.2 (Above 14F(-10C) Diesel Fuel No.1 (Below 14F(-10C))
	Fuel Tank	23 Gallons (68L)
	Engine Crankcase W/Filter	15 Quarts (13.5L) 15W40
	Engine Coolant	5 Gallons (19L) (Recommended Coolant John Deere Cool-Gard)
	Hydraulic Tank	12 Gallons (45L) AW46
	Gear Drive Oil	16 Ounces (.473L) (per side) 80W90
Dimensions	Overall Length	115 in. (294cm)
	Overall Width	57 in. (145cm)
	Overall Height	65 in. (165cm)
	Wheel Base (length)	77 in. (196cm)
	Wheel Base (width)	54 in. (137cm)
	Weight (Chassis)	4480 lbs. (2032kgs) (weight includes approx. 700 to 800 lbs of material)
Traveling System	Front Tire	12" x 4.5" x 8" (31cm X 12cm X 21cm) Non-Marking
	Rear Tire	16" x 6" x 10" (40cm X 13cm X 26cm) Non-Marking
	Steering	Hydraulic Assisted Power
	Brake	Hydraulic Assisted Power
	Travel Speed	3.5 mph (5.63km/h)
Acc.	Weight (BH-18 Blast Head)	900 lbs (409kgs) (weight includes approx. 150 to 200 lbs of blast media)
	Weight (SC-16 Scarifier Head)	600 lbs (273kgs)
	Weight (DG-50 Diamond Grinder/Polisher)	800 lbs (363kgs)
Noise	Sound Level	96 dba

D-1800-FT4

SERVICE INTERVAL CHART

<u>Service Intervals</u>			Indication on hour meter																	
No.	Maintenance Items	Service	D	50	100	150	200	250	300	350	400	450	500	550	600	650	700	Schedule		
1	Engine Oil	Check	X															Daily		
		Change			X						X							Every 400 hrs.		
2	Engine Oil Filter	Replace			X						X							Every 400 hrs.		
3	Hydraulic Fluid	Change			X						X							Every 400 hrs.		
4	Hydraulic Filter	Replace			X						X							Every 400 hrs.		
5	Drive Motor Gear Oil	Change			X						X							Every 400 hrs.		
6	Engine Starting System	Check	X															Daily		
7	Greasing	Lubricate	X															Daily		
8	Batteries	Check				X		X		X		X		X		X		Every 100 hrs.		
9	Air Filters	CK/Replace	X			X		X		X		X		X		X		Every 100 hrs.		
10	Fuel Filter	Replace			X	X		X		X		X		X		X		Every 100 hrs.		
11	PTO Belts	Adjust				X		X		X		X		X		X		Every 100 hrs.		
12	Neutral Switch	Adjust				X		X		X		X		X		X		Every 100 hrs.		
13	Parking Brake	Adjust				X		X		X		X		X		X		Every 100 hrs.		
14	Engine Valve Clearance	Adjust																Every 2000 hrs.		
15	Fuel Injector Pressure	Check																Every 2000 hrs.		
16	Injection Pump	Check																Every 2000 hrs.		
17	Cooling System	Flush																Every 2000 hrs.		
18	Coolant	CK/Replace	X															Daily	*1	
19	Radiator Hoses	CK/Replace	X															Daily	*1	
20	Resistance Block	Lubricate	X			X		X		X		X		X		X		Every 100 hrs.	*1	
21	Blast Head Rear Liner	CK/Replace	X															Daily	*1	
22	Blast Head Blades For Wear	CK/Replace	X	X	X	X	X	X	X	X	X	X	X	X	X	X	X	Every 50 hrs.	*2	
23	Blast Head Liners	CK/Replace	X		X		X		X		X		X		X		X	Every 100 hrs.	*2	
24	Blast Head Brushes	Adjust	X															Daily	*2	
25	Blast Head Rollers	CK/Replace	X	X	X	X	X	X	X	X	X	X	X	X	X	X	X	Every 50 hrs.	*2	
26	Floater Plates	CK/Replace	X	X	X	X	X	X	X	X	X	X	X	X	X	X	X	Every 50 hrs.	*2	
27	Magnets & Shot Hopper	Clean	X															Daily		
28	Dust Collection Filters	CK/Replace			X		X		X		X		X		X		X	Every 100 hrs.	*2	

Legend
 X = Service Performed During Break-In Period
 *1 = Consult John Deere For This Service
 *2 = Operators Discretion To Replace After Inspection



Filter Media Specifications

New filters may “puff” a minuscule amount dust for the first 10 to 15 minutes of use or until the filter is adequately coated with material. The stock filter (10129-H) cleans to 99.7% efficiency at 0.3 micron directly out of the box, and the filter will therefore allow a minimal amount of dust through the filter on every pulsation cycle.

Further tests have shown that humidity and concrete dampness will affect the efficiency of the pulsation system to clean the filter.

#10129-H Spun Bond W/PTFE Coating (Standard Filter in all BW Manufacturing equipment):

- SpunBond P.T.F.E., 70 pleats, 31 Sq. Ft media.
- Efficiency of 99.7% @ 0.3 Microns (Minimum Efficiency Rating Value (MERV) 16 Rating - Out of the box)

#10129-B Cellulose Paper/Polyester Blend Filter (Optional Replacement Filter) :

- 80/20 Blend, 120 pleats, 53 Sq. Ft media.
- Efficiency of 99.9% @ 1.0 Micron with a seasoned (caked) filter.

Technical Notes:

- **OSHA Standard#: 1926.1153 for Respirable crystalline silica requires a filter with 99.0% or greater efficiency.**
- All values are averages
- Specifications are subject to change without notice
- To qualify as HEPA by US government standards, an air filter must remove (from the air that passes through) 99.97% of particles that have a size of 0.3 μm *. HEPA was commercialized in the 1950s, and the original term became a registered trademark and later a generic term for highly efficient filters. Products that claim to be "HEPA-type", "HEPA-like", "HEPA-style" or "99% HEPA" do not satisfy these requirements and may not have been tested in independent laboratories. Some of these sub-par quality filters may come reasonably close to HEPA filtration, while others will fall significantly short, making them truly inferior.

* The symbol μm or micrometer/micron is one thousand of a millimeter, 0.001mm or about 0.000039 inch

D-1800-FT4 CHASSIS SERVICE

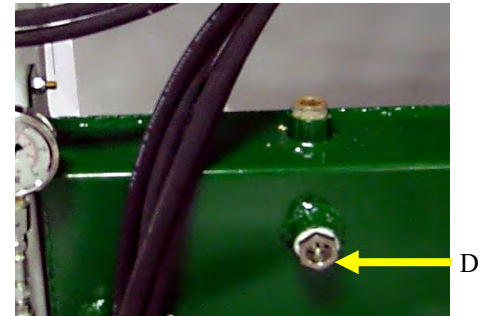

Check all fluids every 10 hours during 100 hour Break-In period

Change engine, hydraulic, and gear drive oil along with all corresponding filters after the first **100** hours of use.

Fluid & Filter Replacement

Engine Oil and Oil Filter (A) should be changed every 400 hours, using the oil drain plug (B)

The Hydraulic Filter (C) and fluid should be replaced every 400 hours, with the fluid level being half-way up the sight glass (D).

The following filters should be changed every 100 hours, the Primary Fuel Filter (E), Secondary Fuel Filter (F), Pre-Air Filter (G) and Main Air Filter (H).

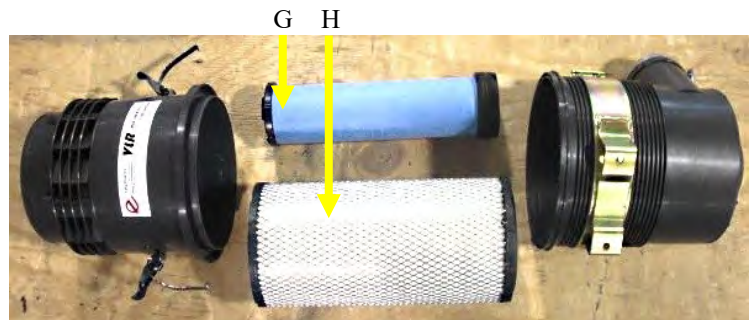
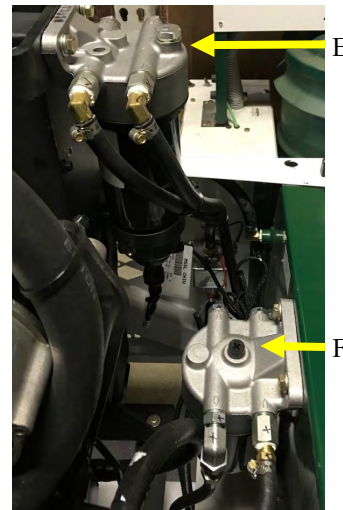

Drain oil from right and left Hydraulic Wheel Motors by removing drain plug (I)
*16 Ounces (.473L) (per side) **80W90**
when completely empty.*

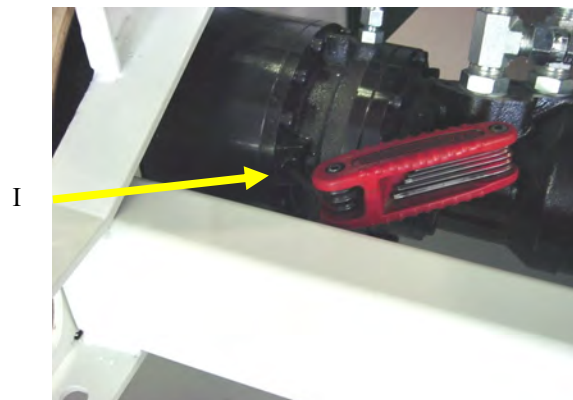

D-1800-FT4

CHASSIS SERVICE

Greasing The Machine

Spindle Mount (A)[x1], Front Wheel Spindle (B)[x1], Lift Support Bushing Tube (C)[x1], PTO Bearing Block (D)[x2], Latch Arm Pivot (E)[x2], Tilt Arm (F)[x1], Pivot Shaft (G & H)[x2], Dust Tray Pivot (I)[x2], Hydraulic Cylinder Pivots (J & K)[x2] be greased every 10 hours of operation with one pump of grease.

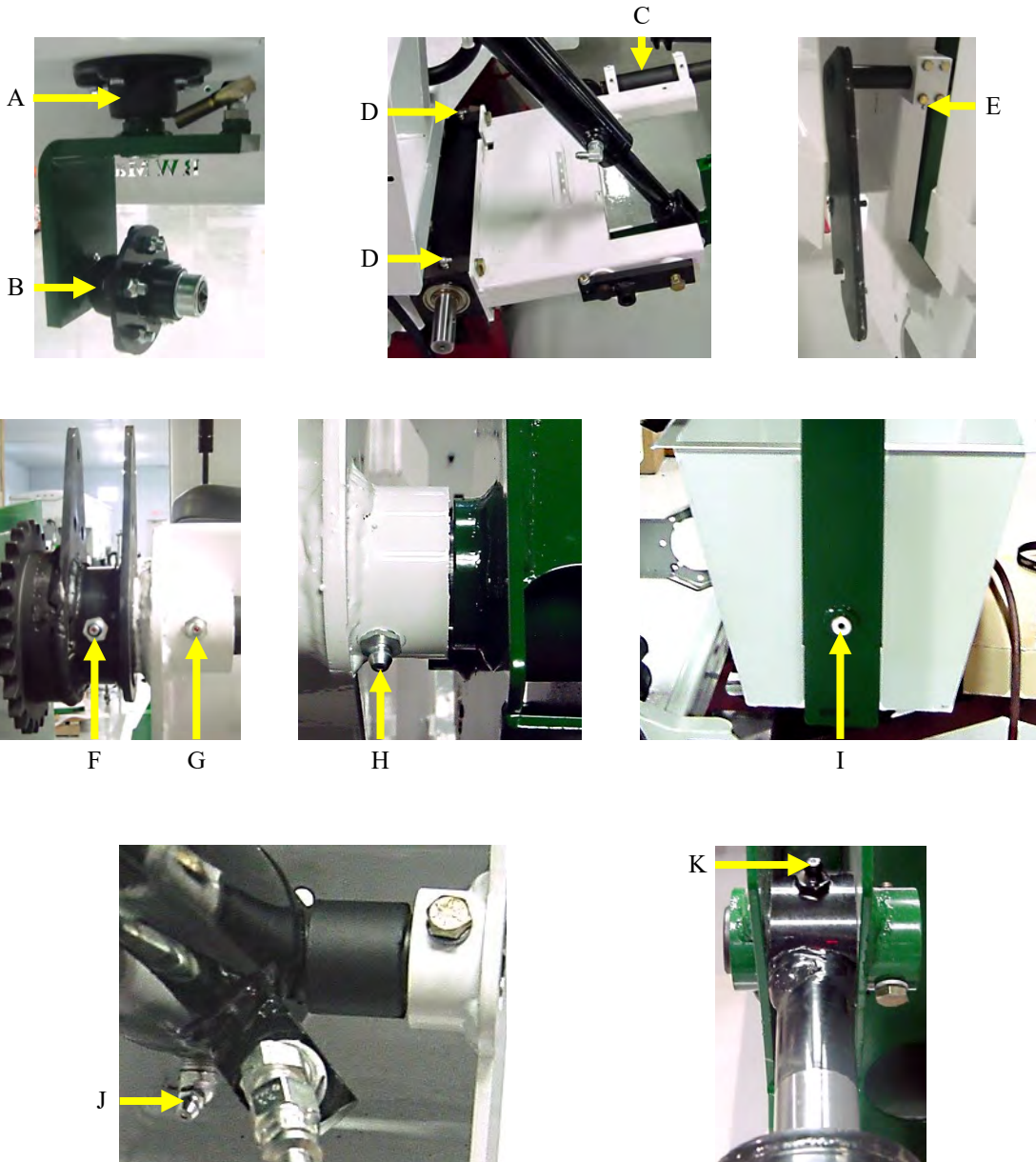

D-1800-FT4 CHASSIS SERVICE

Belt adjustment for PTO shaft.

This is done through the right side of the machine. Loosen the hold down bolt (A), press down on the Clutch Idler Arm (B) so that the belts have no more than 1/2" deflection (C).

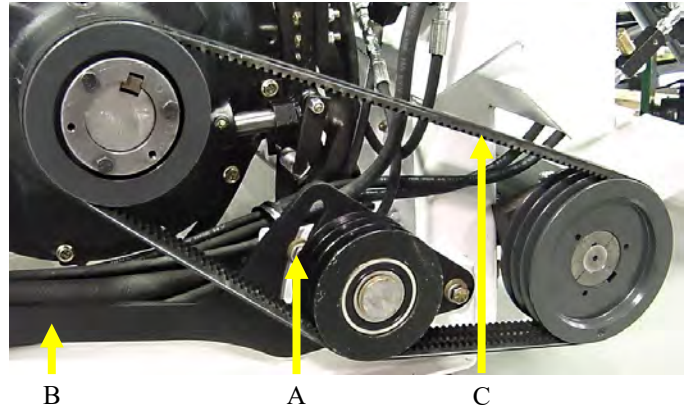

Priming Fuel Pump.

For when unit has been ran out of fuel.

Crack the bleeder screw (A) on top of the Primary Fuel Filter, turn the key to the "ON" position until fuel flows from bleeder. Close primary bleeder and open secondary bleeder located on top of the secondary fuel filter (B) until fuel flows from that bleeder. Close secondary bleeder and the machine will be ready to start.

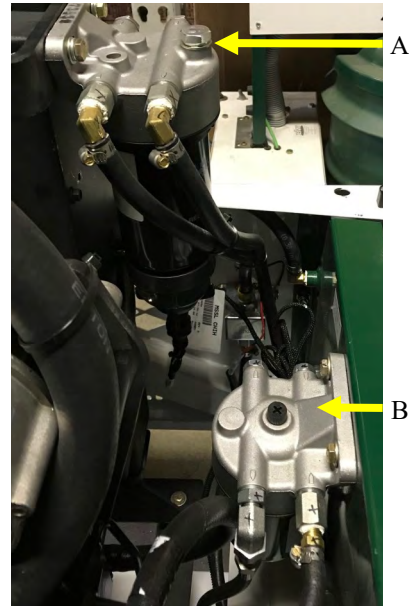

Resistance Block Maintenance

The Resistance Block (A) should be lubricated with a spray lubricant every 10 to 20 hours or as needed if control handle becomes hard to move. If handle moves too freely, tighten bolt that compresses the block (B).

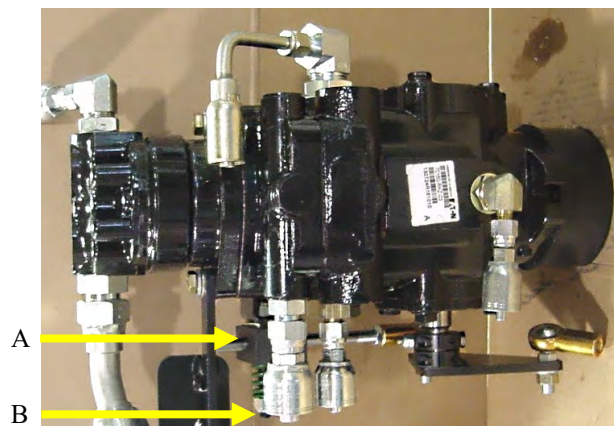

D-1800-FT4

CHASSIS OPERATION

Starting & Operation Instructions

Begin by turning the key to the on position (A). Wait for the control module (B) to go through its cycle and reads XXXX. After the control module has gone through its cycle, the engine is ready to start.

Make sure the battery switch (E) is turned to the “ON” position before starting the engine and in the “OFF” position after shutting the engine down

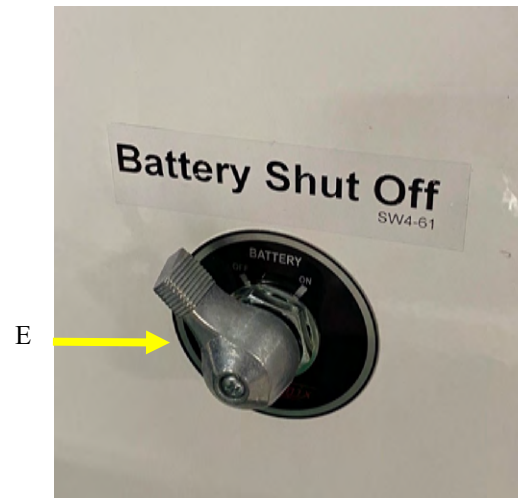

D-1800-FT4 CHASSIS OPERATION

Use the Control Handle Switches (A) to raise and lower the head and (B) turn the attachment on and off. The directional movement of the machine is done with the Control Handle (C).

Once machine is running and at an idle, engage Blower (D) and Clutch (E). Increase engine rpm with the UP ARROW on the control module to wide open throttle for all attachment operation.

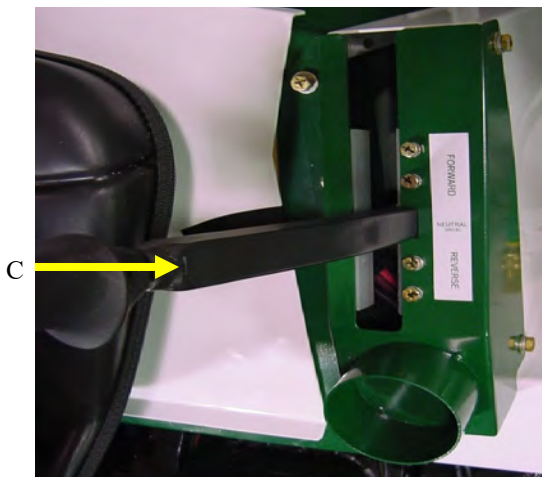
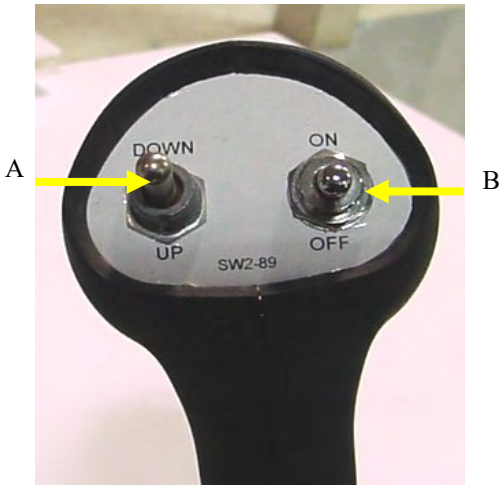

D-1800-FT4

CHASSIS SERVICE

Dump Bucket Adjustment

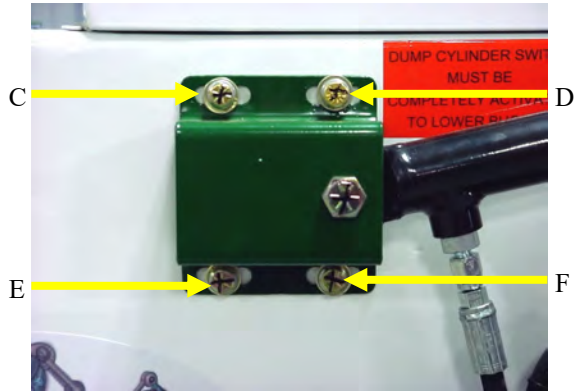

Loosen bolts, (C,D,E,F) on cylinder mount.

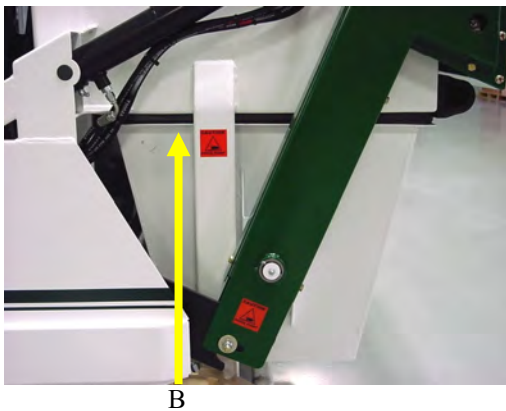

Make sure that the Dust Bin (B) must be completely level with collector and latched.

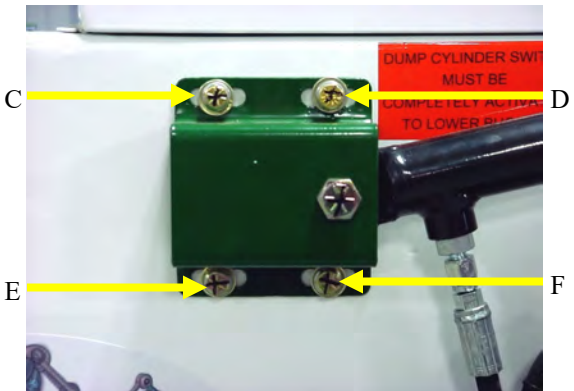

Re-tighten bolts, (C,D,E,F) on cylinder mount.

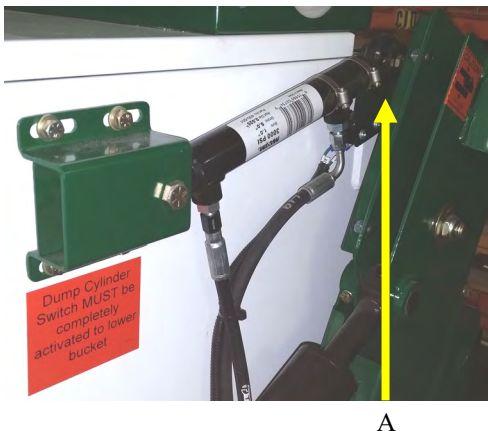

PLEASE NOTE:
Dump tilt cycle must be completed to engage cylinder switch (A) to enable bucket return.

D-1800-FT4 CHASSIS SERVICE

Clogged Filter Light

When the Clogged Dust Filter Light (A) is on that indicates that the dust filters need to be manually cleaned or replaced.



*(Using filters that are **not** designed for collector systems will cause a decrease in vacuum and will reduce paddle and liner life).*

Dust Filter Cleaning & Replacement.

To clean filter manually, rotate the filter and gently tap the filter sides on the ground. Adverse conditions on the filters such as heavy grease, oil, glues, and moisture may require more frequent manual cleaning or replacement.

To determine if you have a bad dust filter.

Watch the indicator lights on the timer board and blower exhaust while the machine is in operation. If a puff of dust follows an indicator light, that filter is bad and should be replaced. Or when inspecting filters you find a layer of dust on the top of the filter inside the rubber seal ring, this is an indication that the filter is bad and needs to be replaced.

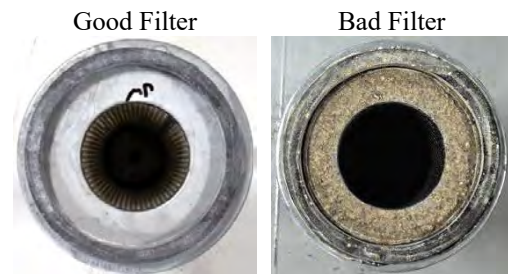

This is the 10129-H Filter that is the stock filter in all BW Manufacturing, Inc. equipment.

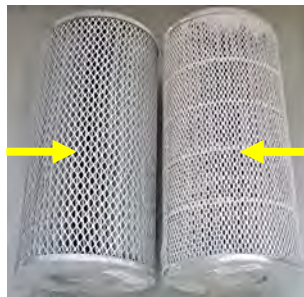

This is a competitors filter.

Both filters were installed in the same machine and you can see that the filter on the right has more pleats along with dust packed near the top rim.



The 10129-H Filter on the left weighs over **2 lbs.** less then the competitors filter due to better air flow during the pulsation process.



D-1800-FT4

CHASSIS SERVICE

Air Pressure Adjustment

Air pressure is set through the Unloader Valve mounted on the side of the compressor (A). To adjust, remove rubber cap, loosen lock nut (B), and turn screw (C) clockwise to **decrease** and counter-clockwise to **increase**, set pressure at 95 to 100 psi max (D) and retighten lock nut (B).

Make sure that the Blower Fan/Pulsation (E) is OFF while making this adjustment.

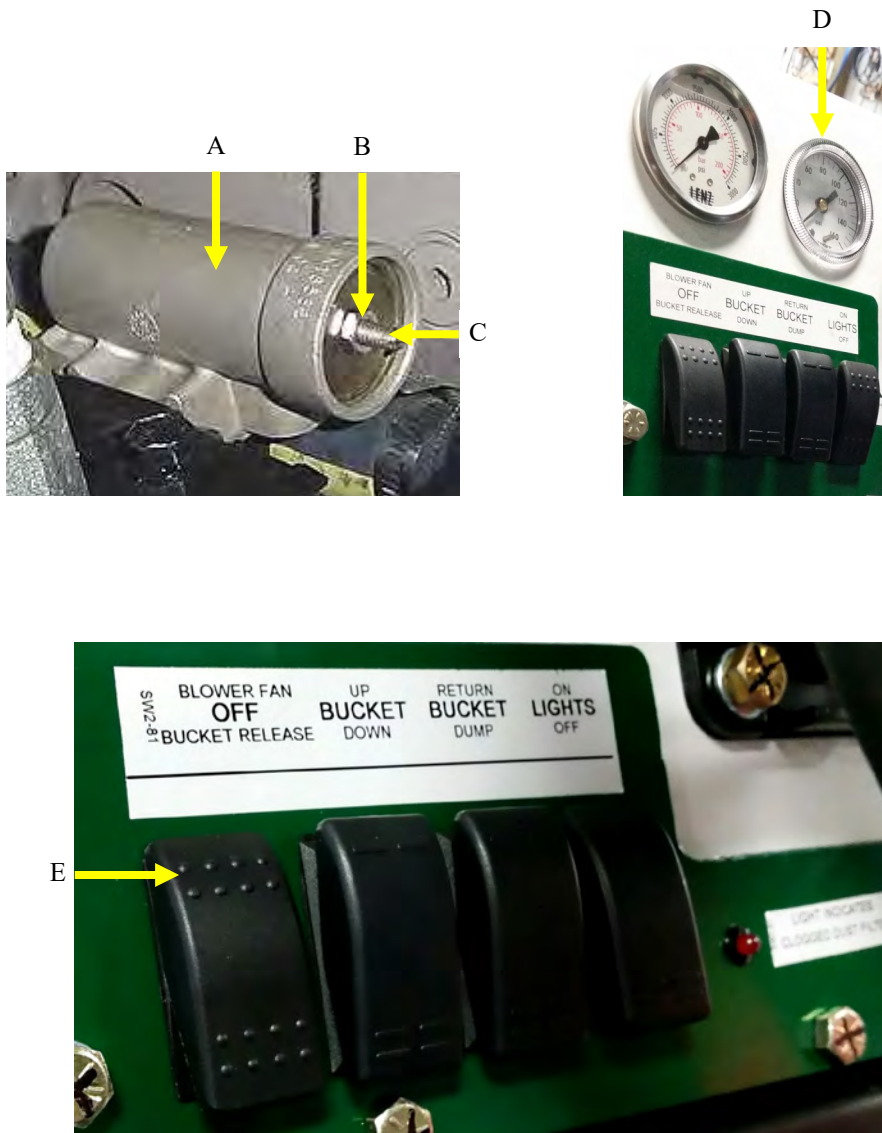

D-1800-FT4 CHASSIS SERVICE

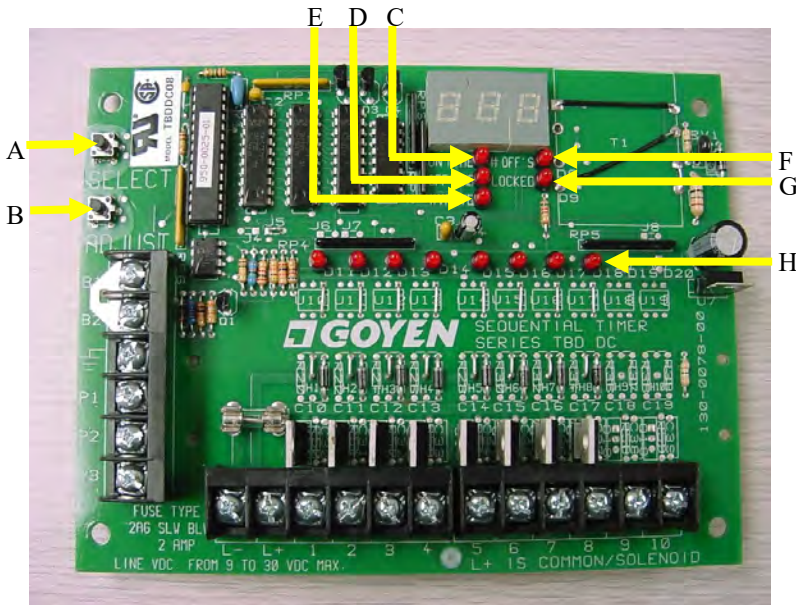

To Set Generation 1 Pulsation Board

1. Press "Select" (A) to illuminate the "On Time" LED (C)
2. Press "Adjust" (B) to the required setting of 30 seconds (030)
3. Press "Select" (A) to illuminate the "Off Time" LED (D)
4. Press "Adjust" (B) to the required setting of 1milliseconds (001)
5. Press "Select" (A) to illuminate the "# Valve" LED (E)
6. Press "Adjust" (B) to the required setting of 8 (008)
7. Press "Select" (A) to illuminate the "# Off's" LED (F)
8. Press "Adjust" (B) to the required setting of all zeros (000)
9. Press "Select" (A) to illuminate the "Locked" & # Off's LED (G)

The indicator lights (H) will come on each time it pulsates a filter.

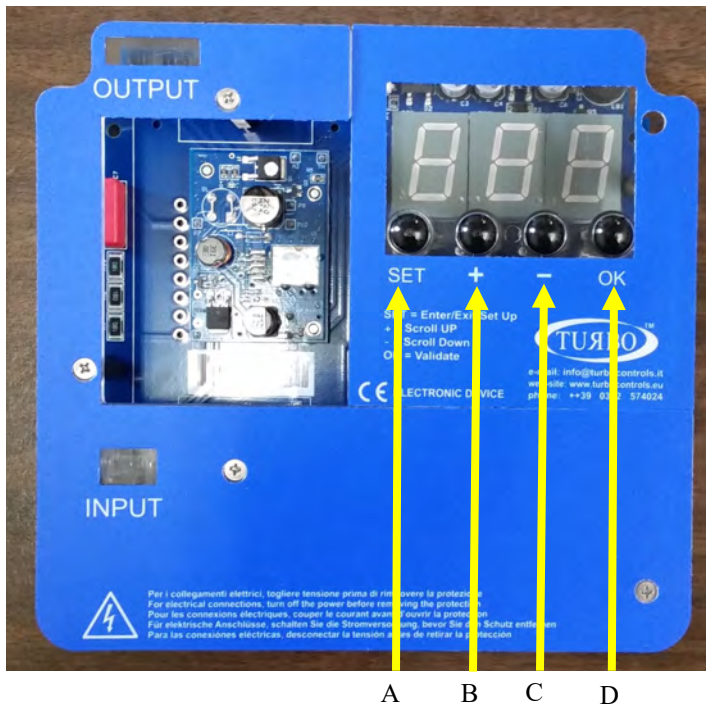

To Set Generation 2 Pulsation Board

1. Press "Set" (A) and F02 will show on display
2. Press "OK" (D) to show Solenoid Valve Activation Time
3. Press "+" or "-" (B or C) to adjust to 0.05
4. Press "OK" (D) to show solenoid pause time
5. Press "+" or "-" (B or C) to adjust to 063
6. Press "OK" (D) to show number of valves
7. Press "+" or "-" (B or C) to adjust to 08
8. Press "OK" (D)
9. Press "SET" (A) and Off will show on the display.

Power Switch

Forward Position = ON
Rearward Position = OFF

When power is ON the "OFF" will be displayed on the digital display

D-1800-FT4 **CHASSIS PARTS** **(BODY GROUP)**

1. C-1731 Hump Hose
2. C-025 Dust Tube
3. C-1820 Manual Container
4. C-1712 Seat
5. H-534-A Battery Door
6. H-597 Floor Pan
7. B-1413-AS Front Wheel
8. H-551-A Right Body Side
9. H-765-A Rear Wheel



1. H-718 Fuel Cap
2. H-572-A4 Hood



D-1800-FT4

CHASSIS PARTS

(BODY GROUP)

1. H-739 Hydraulic Pressure Gauge
2. D-1260 Air Pressure Gauge
3. H-766 Bucket Dump Switch
4. H-766 Bucket Raise/Lower Switch
5. H-768 Blower Fan/Bucket Release Switch
6. Engine Control Display
7. C-1844 Ignition Switch
8. H-535-1 Gauge Panel Mount
9. D-1411 Restricted Filtration Indicator Light
10. H-767 Headlight Switch



1. C-1711 Headlight

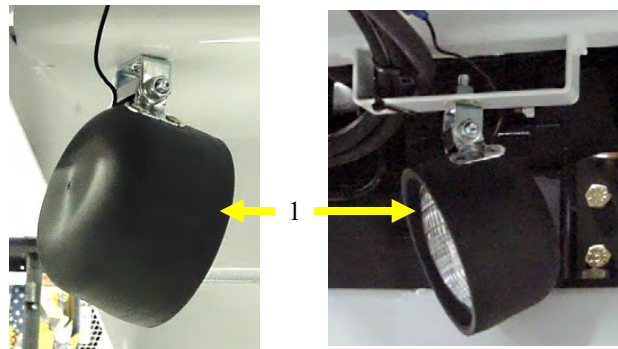

D-1800-FT4

CHASSIS PARTS

(BODY GROUP)

1. L-001-AS Lift plate



1. C-1663 Support Shaft Snap Ring
2. L-010 Support Shaft
3. L-018-AS Lift Support Bushing Tube W/Bushings
4. C-1689 Tension Arm Bushing
5. C-1665 Tension Arm Snap Ring
6. L-008-AS Tension Shaft

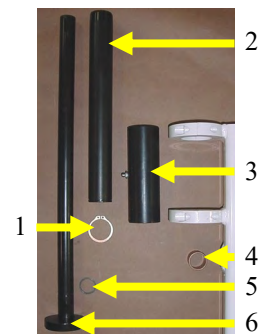

1. 1/2-13x1-1/2 Hex Head Bolt
2. L-0918-AS Tension Shaft Arm
3. C-1689 Tension Arm Bushing
4. 5/16LW Lock Washer
5. 5/16-18x1-1/4 Hex Head Bolt
6. 1/2LW Lock Washer
7. E-2108 Quick Release Pin
8. Q-1237 Clevis Rod End
9. 1/2-20JN Jam Nut
10. O-7018 Head Stop Rod
11. H-107 Rod End

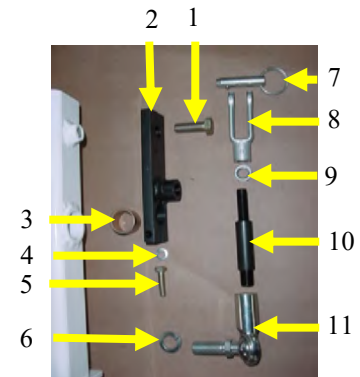

1. L-016-AS Lift Arm
2. 18MMFW Flat Washer
3. L-012 Lower Rear Lift Arm Pin
4. V-1035 Cotter Pin
5. C-1681 Lift Arm Bushing

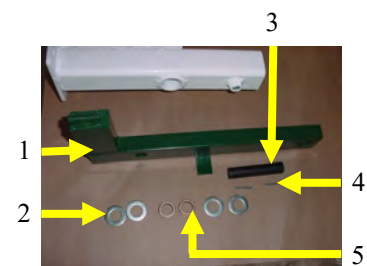

D-1800-FT4

CHASSIS PARTS

(BODY GROUP)

1. C1692 Sheave (PTO Input)
2. C-1683 Bushing (PTO Input)
3. 5/16-18x2FT Hex Head Bolt
4. H-651-AS PTO Bearing Block Assembly
5. H-652-AS Mounted PTO Tube Assembly
6. H-651-AS PTO Bearing Block Assembly
7. F-014 Bushing (PTO Output)
8. H-101 Blast Head Drive Sprocket (BH-18)
9. 5/16-18x2FT Hex Head Bolt
10. C-1714-A Scarifier Head Drive Sprocket (SC-16)

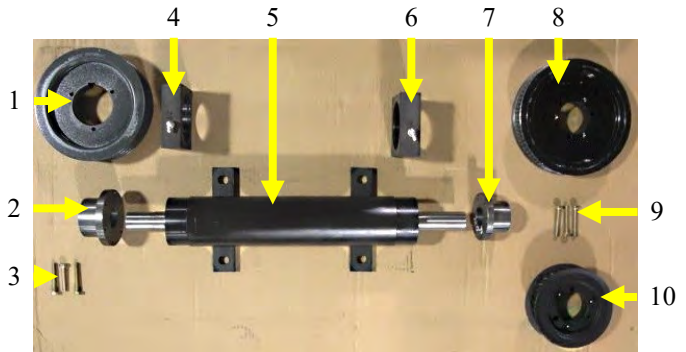

1. C-1710 Hub
2. B-069-AS Steering Rod End
3. 3/4-16JN Jam Nut
4. C-1874 Lug Nut
5. C-1710 Hub
6. C-1710 Hub

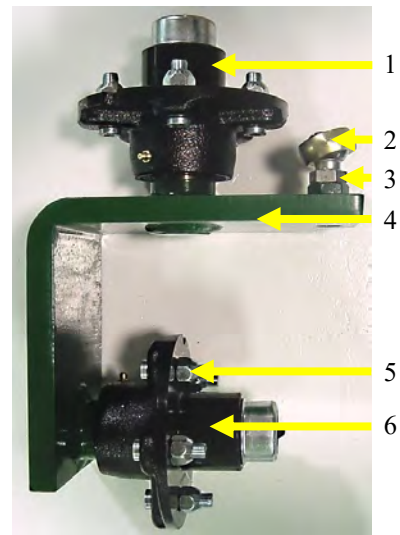

D-1800-FT4

CHASSIS PARTS

(BODY GROUP)

1. H-510 Pivot Shaft Guard
2. H-769 Reflective Vehicle Marking Tape
3. H-638-A Rear Cross Brace
4. H-501-A Dust Tray Assembly

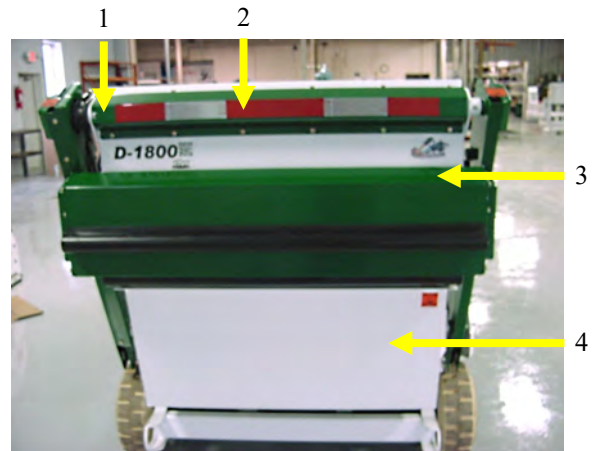

1. H-645 Arm Bumper
2. H-640 Arm Bumper Bolt Plate

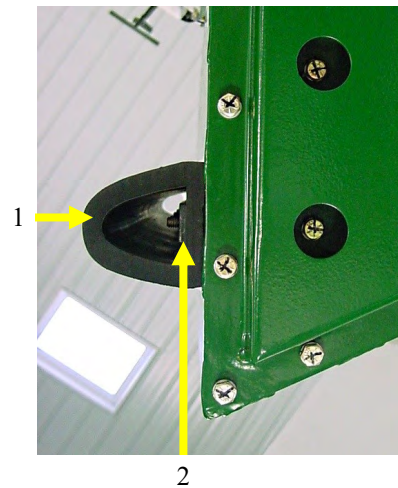

1. H-646 Collector Bumper
2. H-644 Collector Bumper Bolt Plate

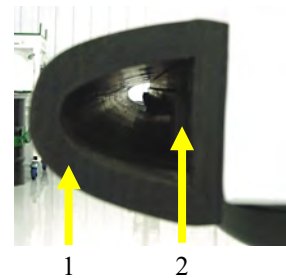

D-1800-FT4 **CHASSIS PARTS** **(BODY GROUP)**

1. H-596-A Front Chain Guard
2. H-626 Upper Lift Cylinder Pin
3. H-519-A Dump Arm (Left)
4. H-712 Idler Sprocket
5. D-1297 Bushing
6. H-568 Idler Spacer
7. H-653 Upper Rear Chain Guard
8. H-724 Snap Ring
9. H-723 Shim
10. H-595-A Rear Chain Guard
11. H-632 Latch Bolt Spacer
12. H-633 Latch Bolt Roller

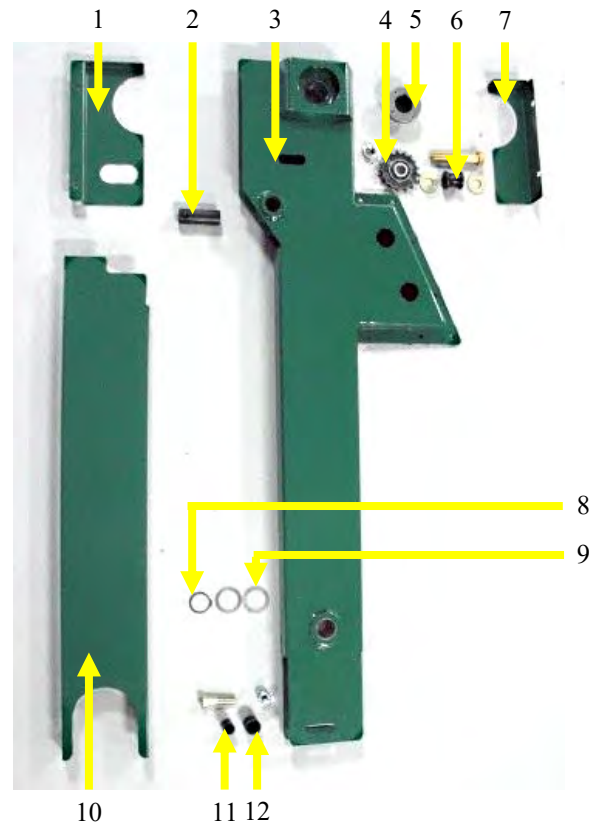

1. D-1297 Bushing
2. H-503-A Dump Arm (Right)
3. H-626 Upper Lift Cylinder Pin
4. H-723 Shim
5. H-724 Snap Ring
6. H-633 Latch Bolt Roller
7. H-632 Latch Bolt Spacer

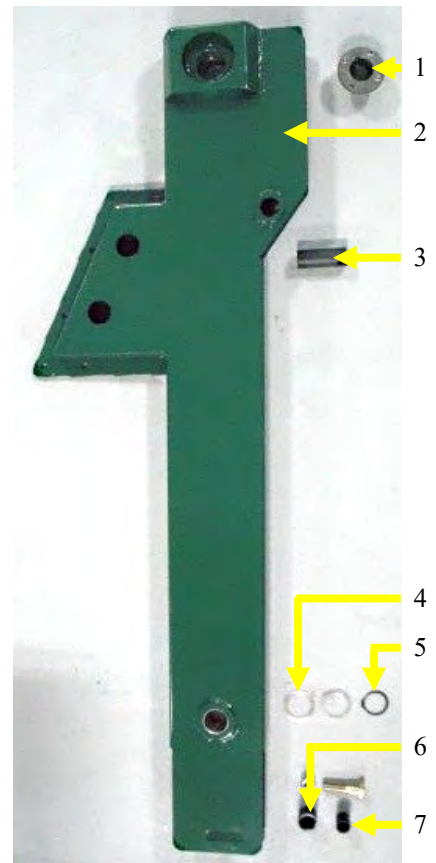

D-1800-FT4

CHASSIS PARTS

(BODY GROUP)

1. H-707-A Tilt Cylinder
2. H-509-A Tilt Arm
3. H-710-A Roller Chain (82")
4. H-712 Idler Sprocket

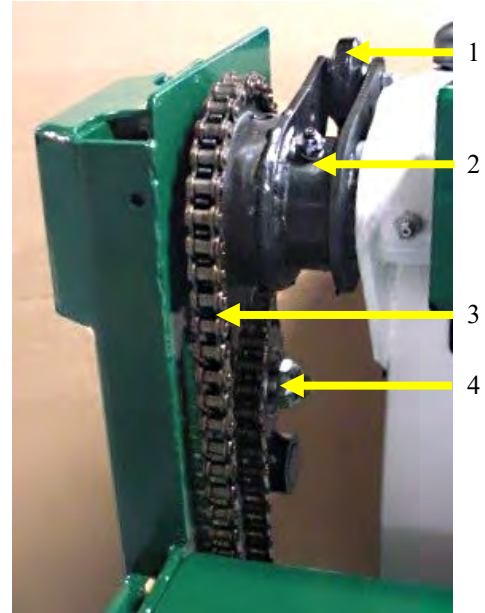

1. H-641-A Latch Arm

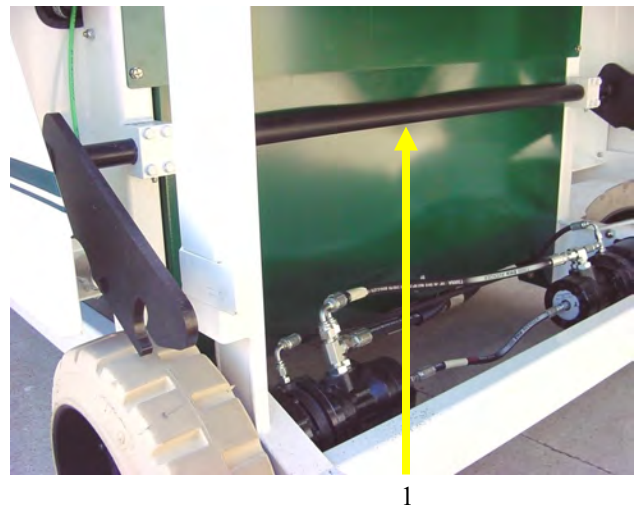

D-1800-FT4 CHASSIS PARTS (BODY GROUP)

1. H-718 Fuel Cap
2. H-528-A Fuel Tank
3. C-1707 Fuel Sending Unit

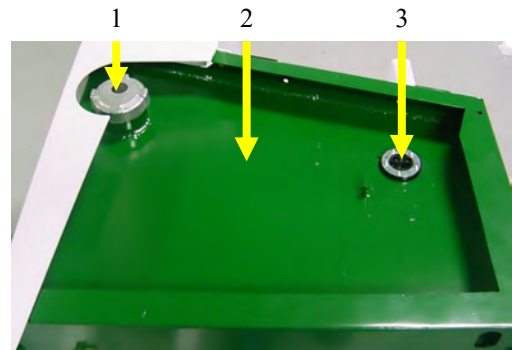

1. H-579-A Seat Plate
2. H-718 Fuel Cap

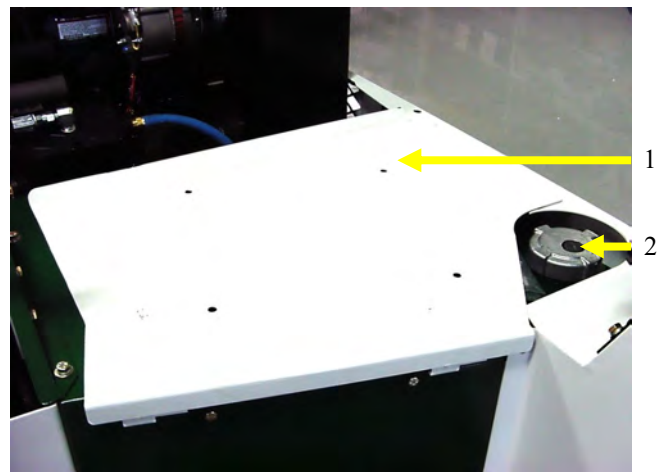

1. C-1712 Seat



D-1800-FT4

CHASSIS PARTS

(BODY GROUP)

1. C-1670 Strut Bracket
2. H-721 Strut



1. A-8629 Grip
2. H-554-A Clutch Lever



1. H-573-A Collector Lid
2. C-1670 Strut Bracket
3. C-1671 Strut End
4. H-721 Strut
5. V-1023 Seal Material (116 Inches)
6. C-1635 Ball Stud



D-1800-FT4 **CHASSIS PARTS** **(BODY GROUP)**

1. H-609 Pump Control Rod
2. C-1631 Rod End
3. H-615-A Handle Tube

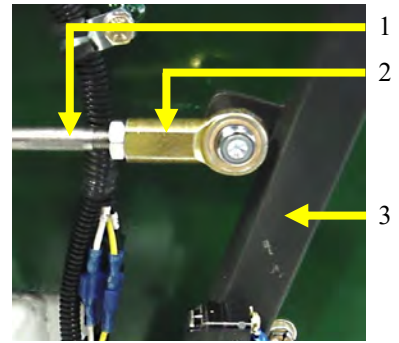

1. H-610-A Control Bar
2. C-1667 Spring

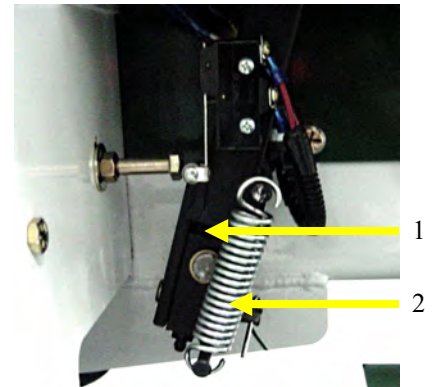

1. H-576 Outer Control Slide
2. H-719 Neutral Switch

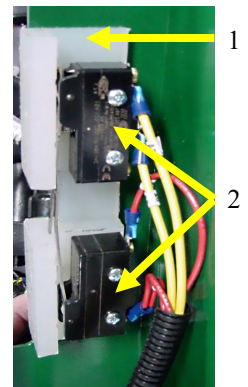

1. H-575-A Control Lever Cover
2. H-577 Inner Control Slide
3. H-615-A Handle Tube
4. H-578-A Control Cover

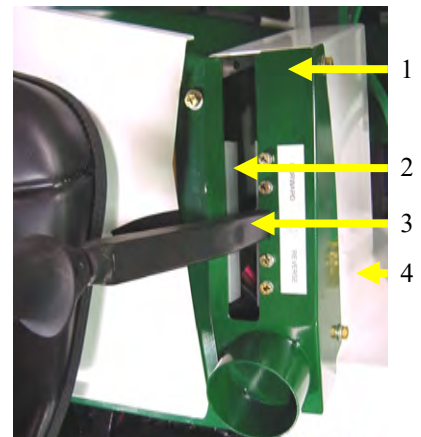

D-1800-FT4 **CHASSIS PARTS** **(BODY GROUP)**

1. 10129-H Filter (HEPA)
2. V-122-AS Filter Nut
3. V-1023 Seal Material (136 Inches)



1. V-122-AS Plastic Filter Nut
2. 10129-H HEPA Filter (Stock Filter)
Optional Filter 10129-B Blend Filter

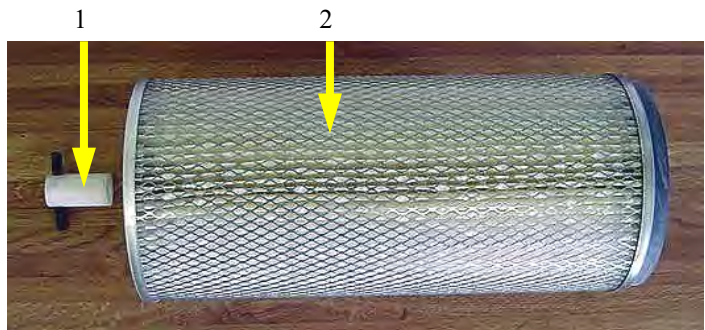

D-1800-FT4

CHASSIS PARTS

(ENGINE GROUP)

1. C-1698 Air Filter
2. C-1697 Pre-Air Filter
3. C-1906 Air Cleaner Housing

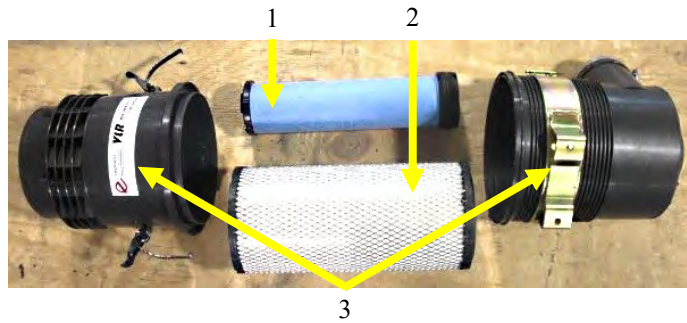

1. **C-1876 Radiator**
2. E-010-AS Left Rear Motor Mount
3. C-1897 Engine Fan
4. C-1995-4 Fan Belt
5. C-1836 Starter
6. E-008-AS Right Rear Motor Mount

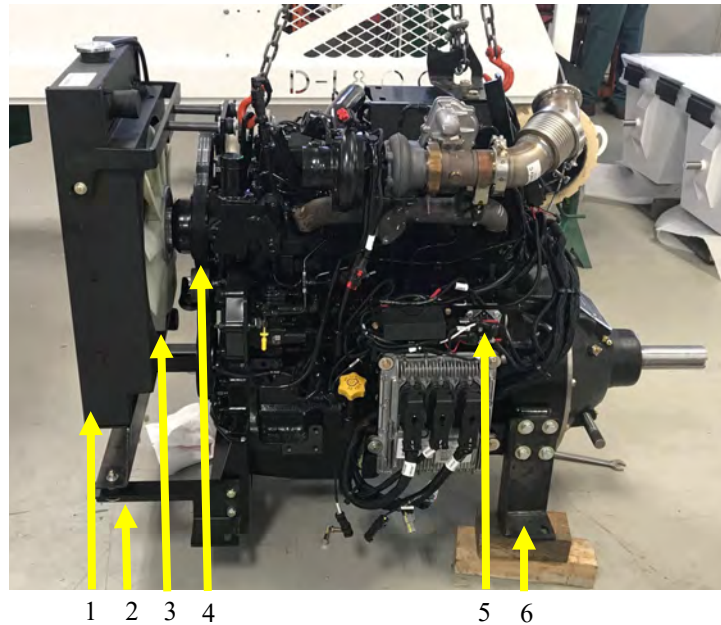

1. H-804-A Hydraulic Drive Pump
2. C-1756 Hydraulic Accessory Pump
3. E-007-AS Right Front Motor Mount
4. C-1867 Engine Oil Filter
5. C-1802 Air Compressor (NEW)
6. E-006-AS Left Front Motor Mount
7. C-1994 Alternator

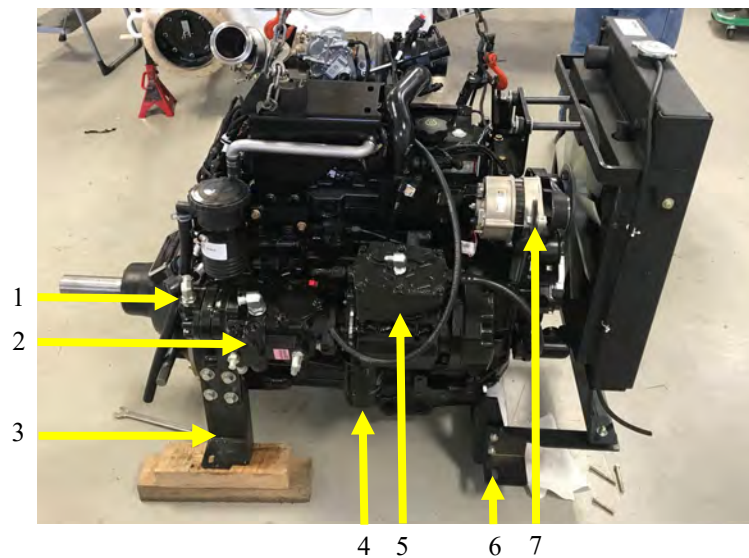

D-1800-FT4

CHASSIS PARTS

(ENGINE GROUP)

1. H-567-A Support Strut

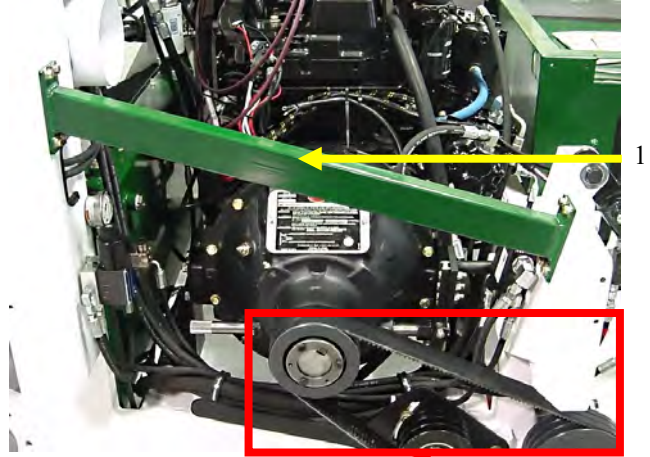

(Inset Photo)

1. C-1657-A Clutch Key Stock
2. C-1693 Sheave (Clutch)
3. C-1682 Bushing (Engine)
4. H-606-AS Clutch Idler Arm Assembly
5. C-1692 Sheave (PTO Input)
6. C-1683 Bushing (PTO Input)

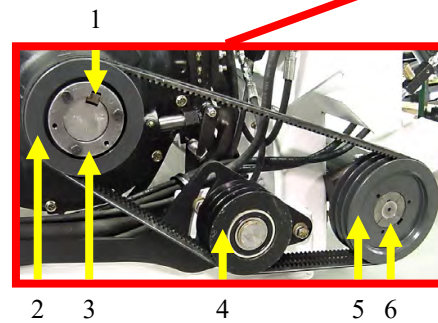

1. H-606-A Clutch Idler Arm
2. C-1663 Snap Ring
3. E-1213 Bearing
4. H-583 Clutch Idler Sheave

*Unit can be purchased as an assembly
using part number H-606-AS*

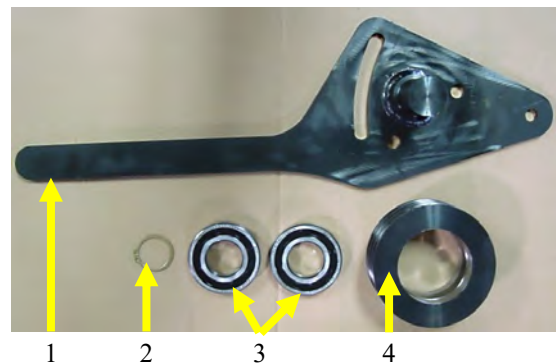

D-1800-FT4 CHASSIS PARTS (ENGINE GROUP)

1. C-1639 Hose Clamp
2. H-745 Intake Hose (3" x 90 deg.)
3. C-1639 Hose Clamp
4. H-627-A Intake Adapter
5. C-1639 Hose Clamp
6. H-744 Intake Hose (3-1/2" x 90 deg.)
7. C-1639 Hose Clamp
8. C-1797 Hose Clamp
9. H-123 Hose (1"ID x 36")

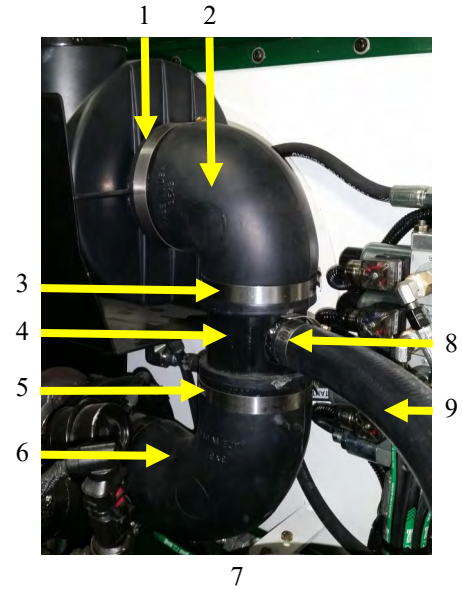

1. H-816 Exhaust Rain Cap
2. H-829 Radiator
3. C-1843-AT Muffler (Turbo)
4. C-1906 Air Cleaner Housing

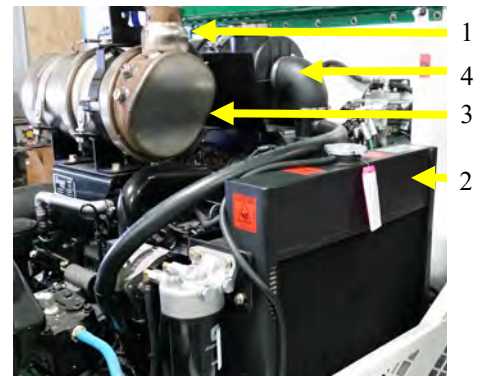

D-1800-FT4

CHASSIS PARTS

(ENGINE GROUP)

1. C-1970 Compressor Flange
2. E-005-AS Hydraulic Pump Adapter
3. C-1868 Gasket "A" Style (*not shown*)

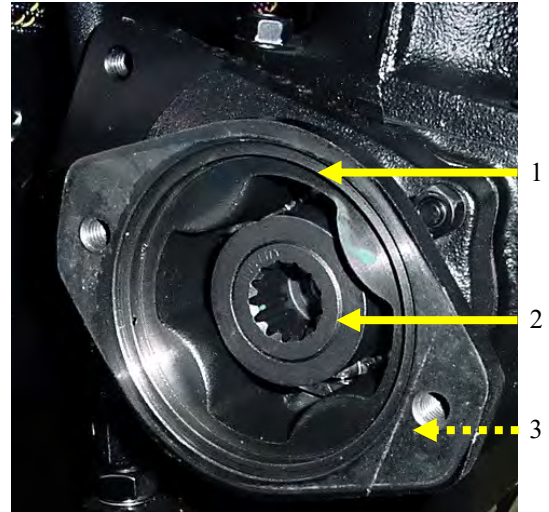

1. H-830 Radiator Hose (UPPER)
2. E-017 Upper Radiator Mount

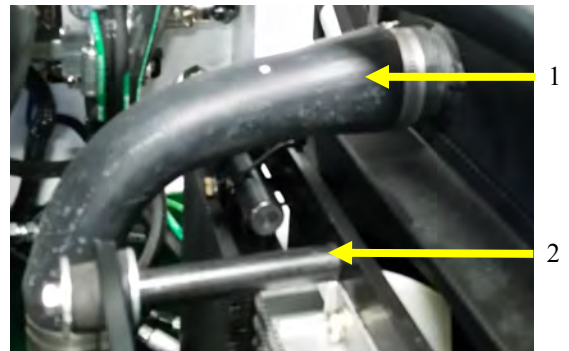

1. H-831 Radiator Hose (LOWER)

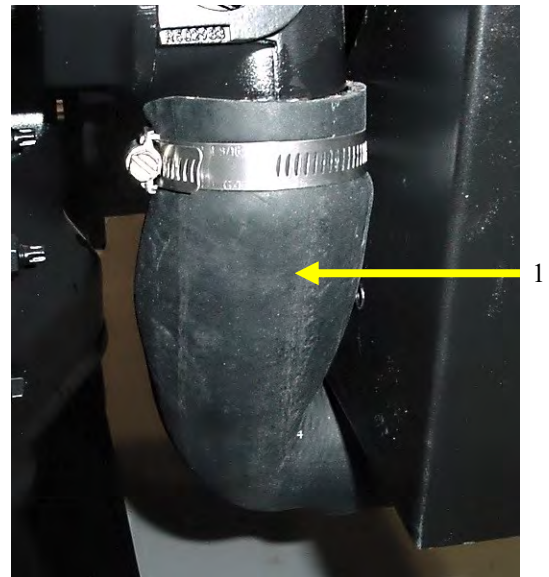

D-1800-FT4 CHASSIS PARTS (HYDRAULIC GROUP)

1. C-1769 Adapter
2. C-1927 Fitting
3. C-1747 Adapter
4. H-729 Suction Strainer

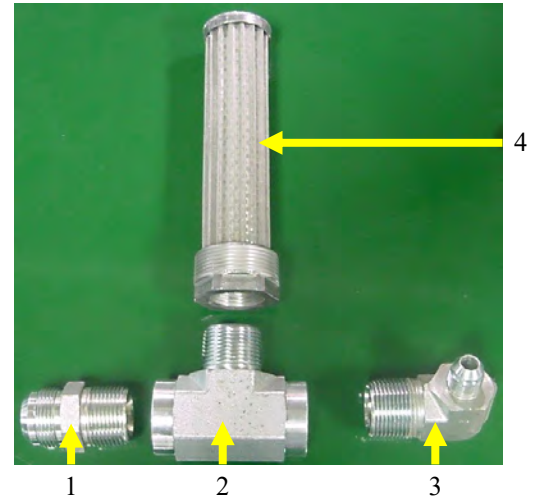

1. D-1212 Adapter
2. C-1919 Adapter
3. H-708 Hyd. Tank Sight Glass
4. D-1264 Fitting
5. C-1918 Adapter
6. C-1916 Adapter
7. C-1917 Adapter

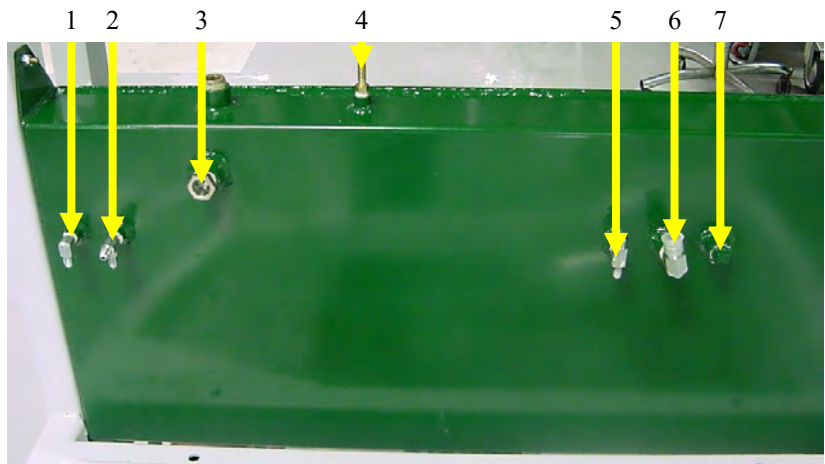

1. C-1966 Brake Valve to Tank (not shown)
2. C-1951 Flow Divider to Tank (not shown)
3. C1940 Drive Pump Drain T to Tank (not shown)
4. C-1943 blower Motor Drain
5. C-1939 Right Drive Drain to T
6. C-1956 Filter to Hydraulic Tank
7. C-2006 Valve Body to Tank

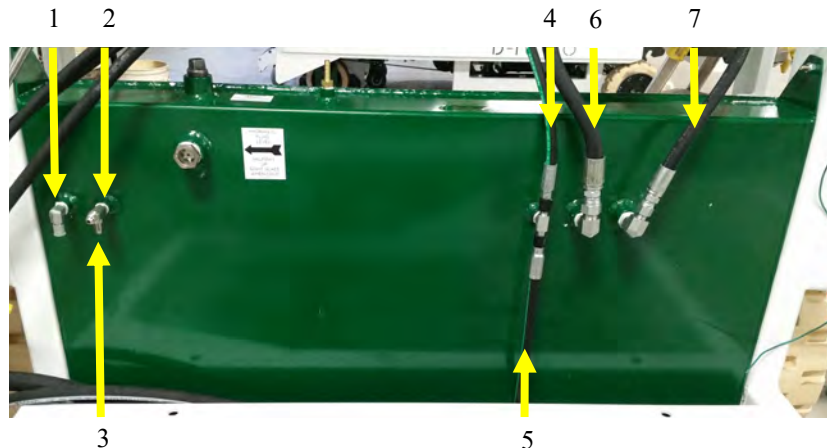

D-1800-FT4

CHASSIS PARTS

(HYDRAULIC GROUP)

1. C-1926 Adapter
2. C-1756 Accessory Pump
3. C-1748 O-Ring (*not shown*)
4. C-1771 Adapter
5. H-804 Drive Pump
6. C-1925 Adapter
7. C-1775 Adapter
8. E-003-AS Hydraulic Pump Mount
9. C-1772 Adapter
10. C-1985 Adapter

** NOTICE **

When installing a new Hydraulic Pump H-804, make sure that oil level is at or above the centerline of the pump. This can be checked at the case drain (A)

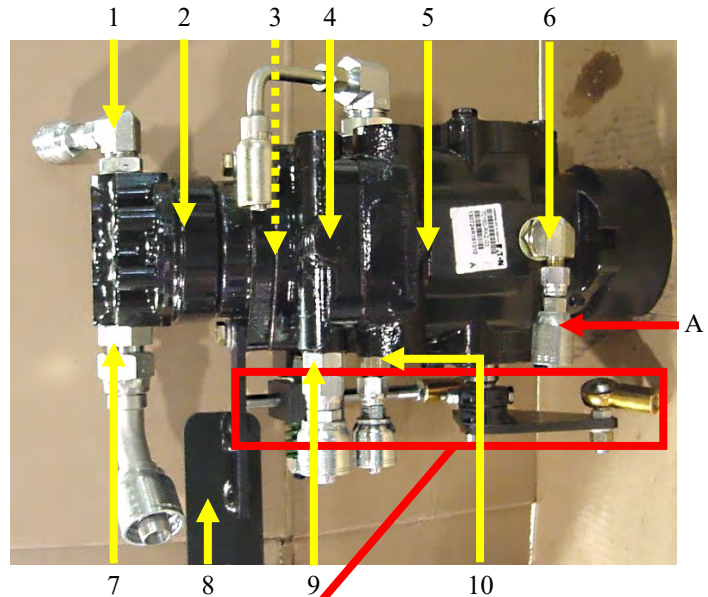

Inset Photo

1. C-1631 Rod End
2. E-011-AS Pump Control Arm
3. C-1631 Rod End
4. H-612 Resistance Rod
5. E-013 Resistance Block
6. H-752 Resistance Spring
7. 3/8-16NLN Nylon Lock Nut
8. H-757 Resistance Block Stud

Reverse View

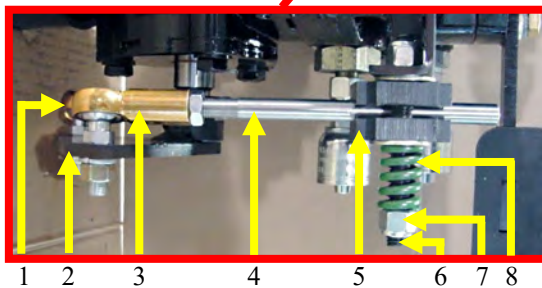

1. C-1967 Gear Pump to Flow Divider Hose
2. C-1957 Upper Drive Pump to Left Drive Motor Hose
3. C-1940 Drive Pump Drain "T" to Tank Hose
4. C-1958 Lower Drive Pump to Left Drive Motor Hose
5. C-1933 Tank to Drive Pump Hose
6. C-1968 Tank to Drive Pump Hose

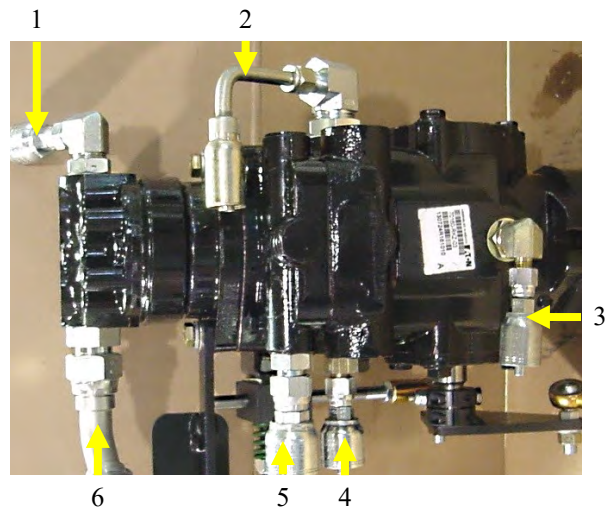

D-1800-FT4 CHASSIS PARTS (HYDRAULIC GROUP)

1. H-715 Hydraulic Valve Assembly
2. H-801 Hydraulic Snubber (.035)
3. C-1923 Adapter
4. H-800 Hydraulic Snubber (.015)
5. C-1923 Adapter
6. C-1912 Adapter
7. C-1770 Adapter
8. C-1912 Adapter
9. D-1214 Adapter
10. C-1770 Adapter
11. D-1212 Adapter
12. C-1770 Adapter
13. D-1212 Adapter
14. C-1999 Plug
15. C-1770 Adapter
16. C-1912 Adapter

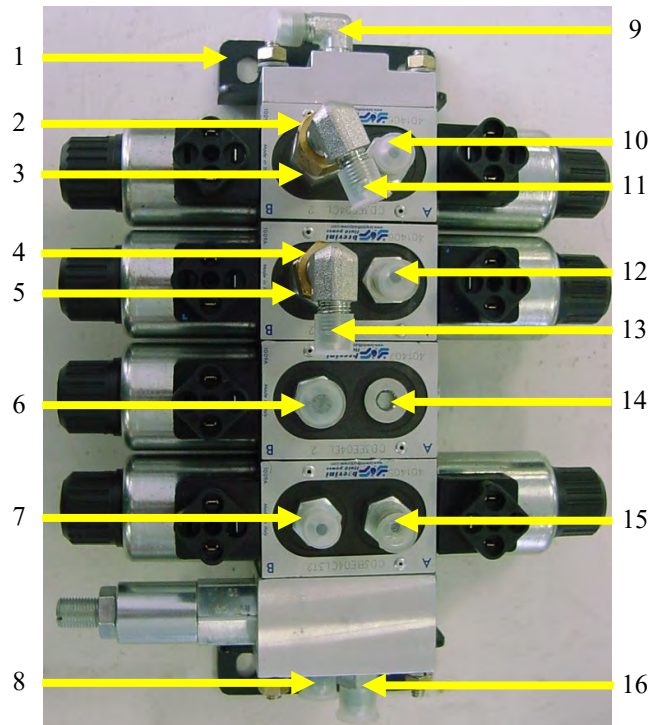

H-715 Hydraulic Valve Assembly Breakdown

1. H-599 Valve Mount Bracket
2. H-774 End Plate (Outlet)
3. H-735 Dump/Tilt Valve
4. H-735 Dump/Tilt Valve
5. H-734 Blower Motor Valve
6. H-733 Lift Cylinder Valve
7. H-773 Pressure Relief Valve
8. H-775 End Plate (Inlet)
9. H-777 Valve Block Rod
10. 1/4-20N Hex Nut
11. 1/4LW Lock Washer

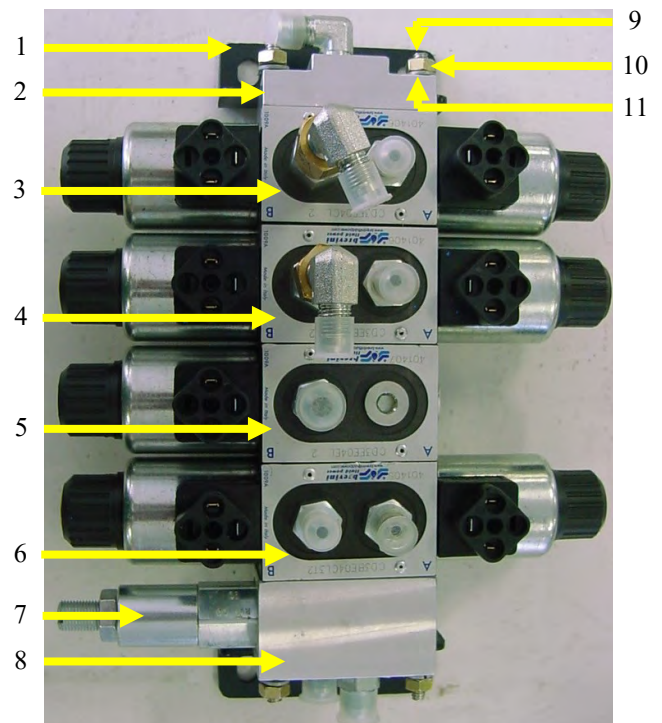

D-1800-FT4

CHASSIS PARTS

(HYDRAULIC GROUP)

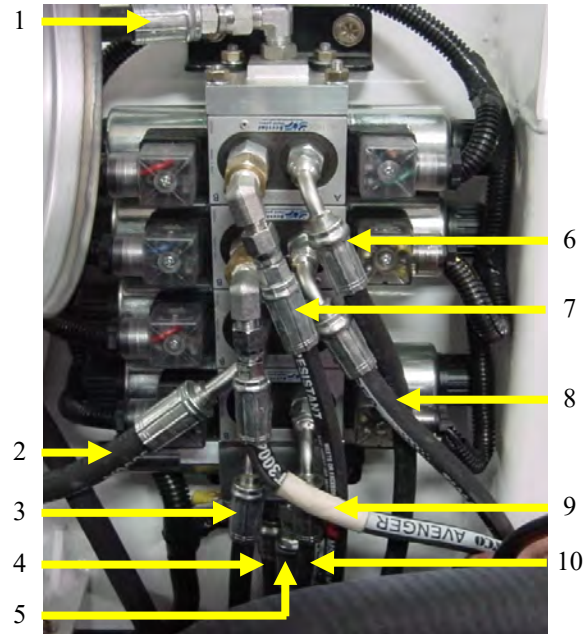

1. C-1965 Blower Return to Cooler Hose
2. C-1955 Valve Body to Blower Hose
3. C-1941 Lift Cylinder to Valve Hose (Bottom)
4. C-1963 Flow Divider to Valve Hose
5. C-2006 Valve Body to Tank Hose
6. C-1947 Valve to Dump Hose (Down)
7. C-1946 Valve to Dump Hose (Up)
8. C-1948 Valve to Tilt Cylinder (Up)
9. C-1949 Valve to Tilt Cylinder (Down)
10. C-1942 Lift Cylinder to Valve Hose (Top)

D-1800-FT4

CHASSIS PARTS

(HYDRAULIC GROUP)

1. C-1738 Steering Orbital
2. C-1794 Adapter
3. C-1954 Flow Divider to Steering Hose
4. C-1953 Steering to Flow Divider Return Hose

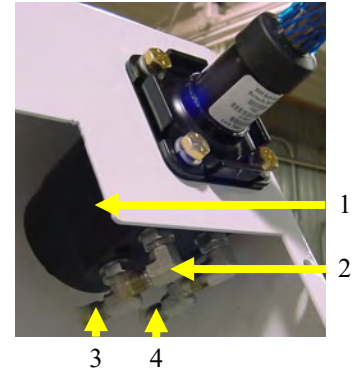

1. B-069-AS Steering Rod End
2. H-600 Steering Cylinder Mount
3. C-1794 Adapter
4. C-1637 Steering Hose (Left to Cylinder Rear)
5. C-1789 Steer Cylinder
6. C-1936 Steering Hose (Right to Cylinder Front)
7. C-1794 Adapter

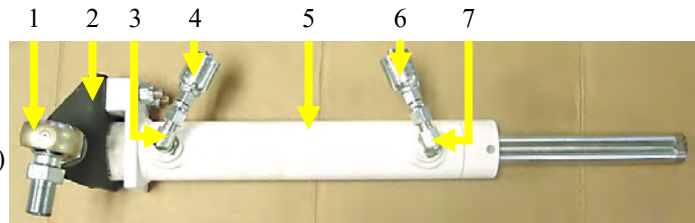

1. C-1833 Steering Wheel
2. H-704 Steering Column
3. C-1834 Steering Wheel Nut
4. C-1835 Steering Wheel Cap



D-1800-FT4

CHASSIS PARTS

(HYDRAULIC GROUP)

1. H-739 Hydraulic Gauge
2. D-1212 Adapter

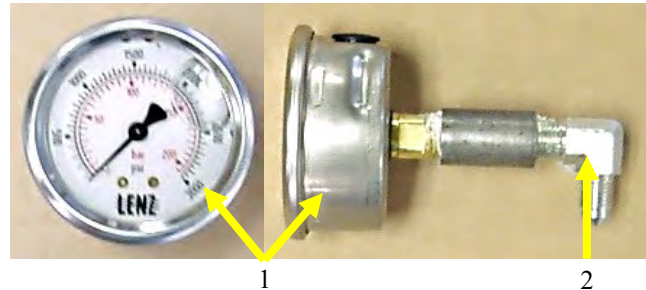

1. C-1952 Flow Divider To Gauge Hose
2. C-1930 Adapter
3. C-1924 Adapter
4. C-1791 Flow Divider
5. D-1211 Adapter
6. C-1953 Steering To Flow Divider Return Hose
7. C-1967 Gear Pump To Flow Divider Hose
8. C-1918 Adapter
9. C-1951 Flow Divider To Tank Hose
10. C-1954 Flow Divider To Steering Hose
11. C-1925 Adapter
12. C-1963 Flow Divider To Valve Hose

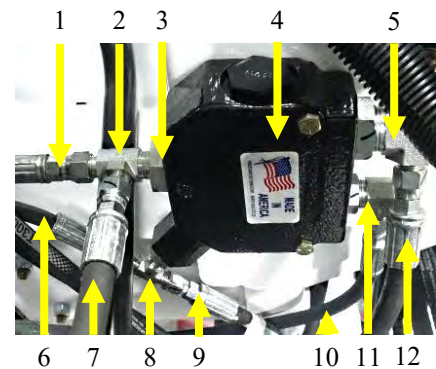

1. H-626 Lift Cylinder Pin (UPPER)
2. 1SAEFW Flat Washer
3. SC-1646 Cotter Pin
4. C-1736 Lift Cylinder
5. C-1794 Adapter
6. C-1758 Adapter
7. C-1788 Flow Control Valve
8. C-1764 Adapter
9. C-1794 Adapter
10. C-1758 Adapter
11. C-1788 Flow Control Valve
12. C-1764 Adapter
13. C-1941 Lift Cylinder to Valve Hose (Bottom)
14. C-1942 Lift Cylinder to Valve Hose (Top)

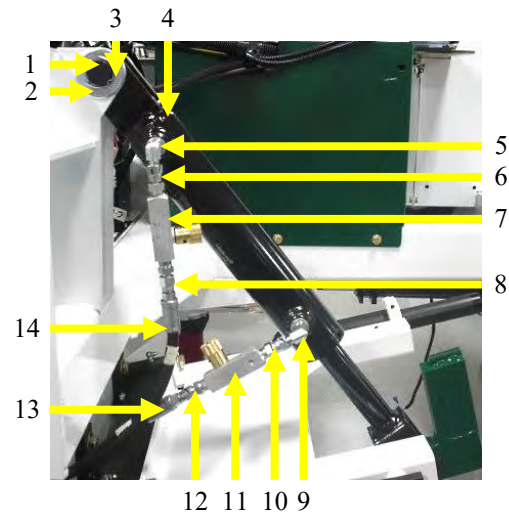

D-1800-FT4

CHASSIS PARTS

(HYDRAULIC GROUP)

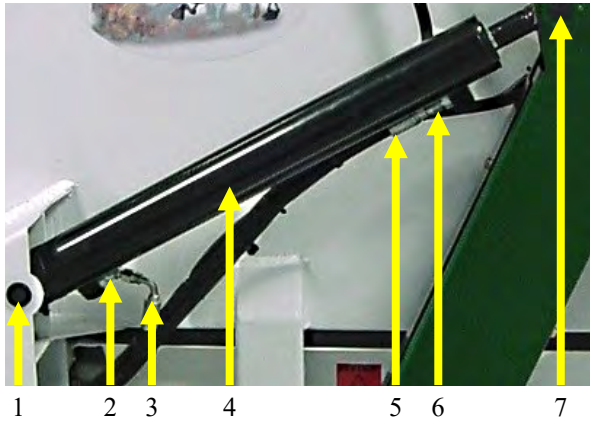

1. H-511-L Lower Dump Cylinder Pin (LEFT)
2. C-1795 Adapter
3. C-1972 Bucket Up Left Side Hose
4. H-705 Dump Cylinder
5. C-1974 Bucket Down Left Side Hose
6. C-1770 Adapter
7. H-626 Upper Dump Cylinder Pin

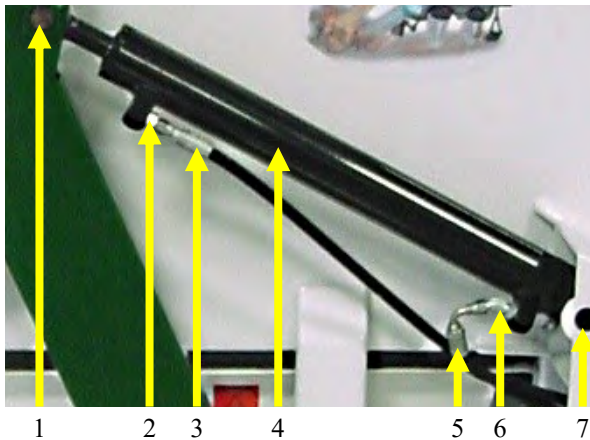

1. H-626 Upper Dump Cylinder Pin
2. C-1770 Adapter
3. C-1973 Bucket Down Right Side Hose
4. H-705 Dump Cylinder
5. C-1971 Bucket Up Right Side Hose
6. C-1795 Adapter
7. H-511-R Lower Dump Cylinder Pin (RIGHT)

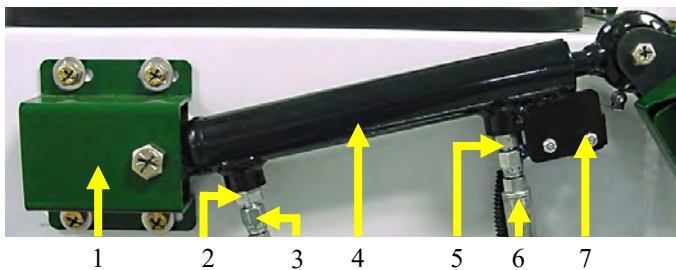

1. H-593-A Tilt Cylinder Mount
2. C-1770 Adapter
3. C-1948 Valve to Tilt Cylinder Hose (Up)
4. H-707-A Tilt Cylinder
5. C-1770 Adapter
6. C-1949 Valve to Tilt Cylinder Hose (Down)
7. C-1853 Switch

D-1800-FT4

CHASSIS PARTS

(HYDRAULIC GROUP)

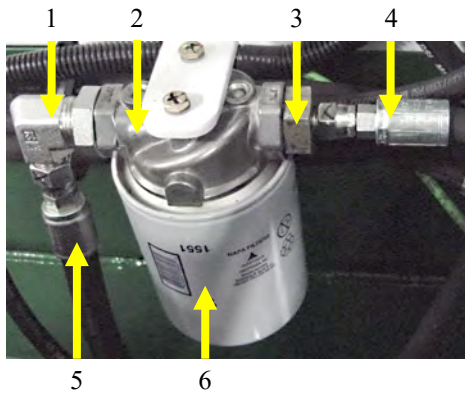

1. C-1778 Adapter
2. C-1793 Filter Head
3. C-1985 Adapter
4. C-1964 Oil Cooler (Bottom) to Filter Hose
5. C-1956 Filter Hydraulic to Tank Hose
6. C-1703 Hydraulic Oil Filter

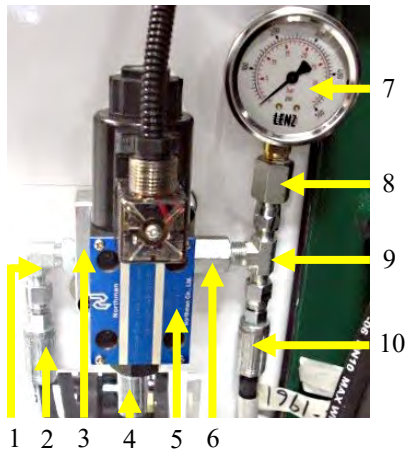

1. C-1794 Adapter
2. C-1966 Brake Valve to Tank Hose
3. D-1208 Brake Valve Sub Plate
4. C-1960 Drive Pump to Brake Valve Hose
5. D-1207 Brake Valve
6. C-1923 Adapter
7. C-1921 Hydraulic Pressure Gauge
8. C-1991 Adapter
9. C-1918 Adapter
10. C-1961 Brake Valve to Wheel Brake Hose

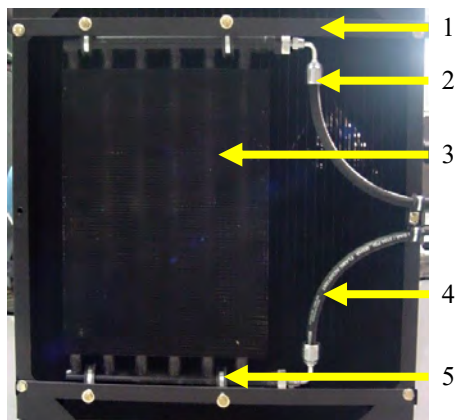

1. H-582 Hydraulic Cooler Mount
2. C-1965 Blower Return to Cooler Hose
3. C-1785 Hydraulic Oil Cooler
4. C-1964 Oil Cooler (Bottom) to Filter Hose
5. H-701 Cushion Strap

D-1800-FT4

CHASSIS PARTS

(HYDRAULIC GROUP)

1. H-713-A Planetary Wheel Drive & Motor
2. C-1931 Adapter
3. C-1759 Adapter
4. C-1759 Adapter

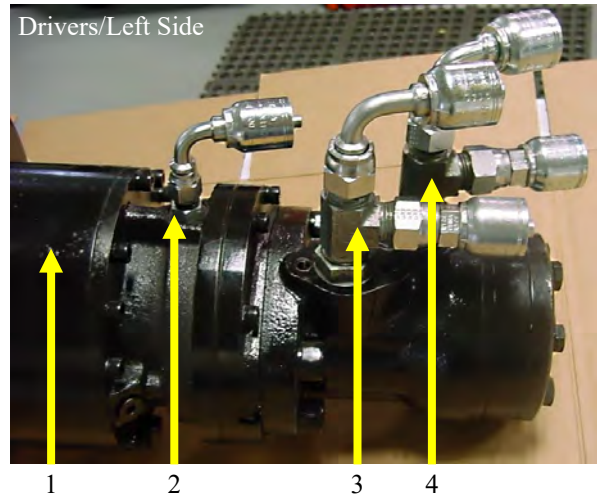

1. C-1926 Adapter
2. C-1926 Adapter
3. H-713-A Planetary Wheel Drive & Motor
4. C-1781 Adapter

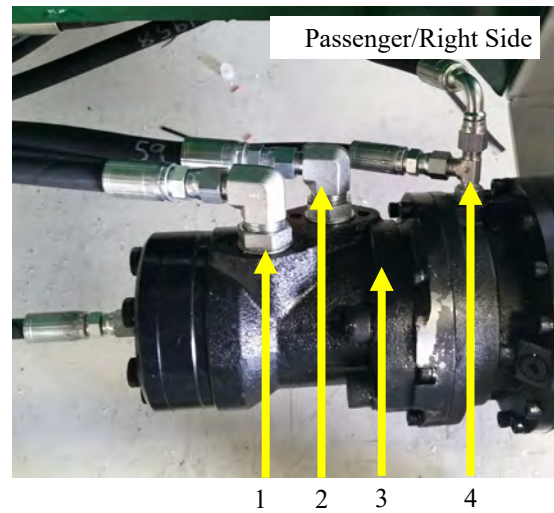

1. C-1961 Brake Valve to Wheel Brake Hose
2. C-1959 Wheel Motor Cross Over Hose
3. C-1959 Wheel Motor Cross Over Hose
4. C-1934 Right Wheel Motor to Wheel Brake Hose
5. C-1958 Lower Drive Pump to Left Drive Motor Hose
6. C-1957 Upper Drive Pump to Left Drive Motor Hose
7. C-1939 Right Drive Drain To "T" Hose
8. C-1938 Drive Motor Drain Cross Over Hose

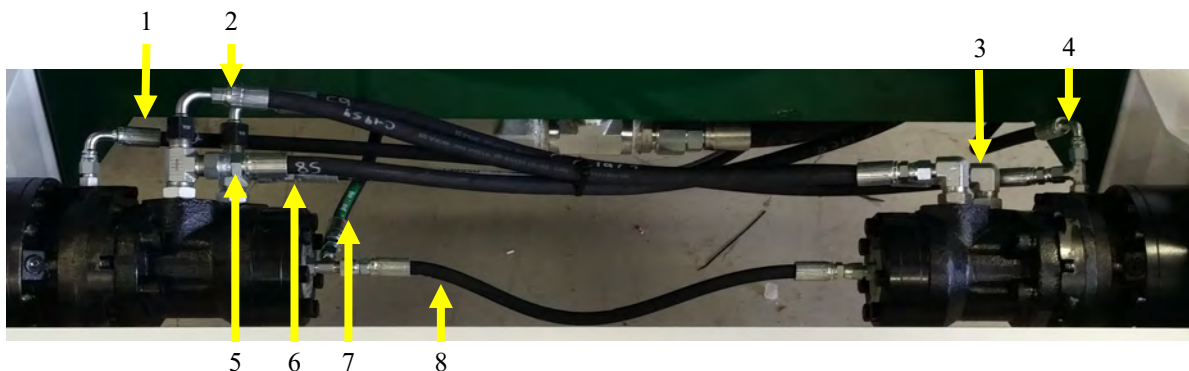

D-1800-FT4

CHASSIS PARTS

(HYDRAULIC GROUP)

1. C-1930 Adapter
2. C-1924 Adapter
3. C-1739-AS Blower Motor
4. D-1211 Adapter
5. C-1955 Blower Return to Cooler Hose
6. C-1950 Blower Motor To Oil Cooler Hose
7. C-1770 Adapter
8. C-1943 Blower Motor Drain Hose
9. C-1965 Valve Body To Blower Motor Hose

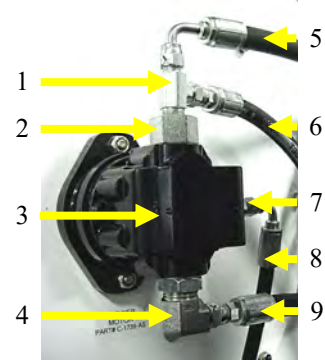

1. C-1611 Blower Fan
2. C-015 Blower Fan Adaptor
3. C-1739-AS Blower Motor

*****CAUTION*****
DO NOT HAMMER OR FORCE
BLOWER FAN ON MOTOR.

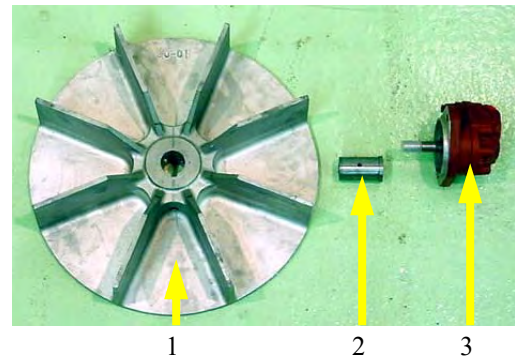

1. C-035 Blower Washer
2. 1/4USSFW Flat Washer
3. 1/4-20x1-1/4 Hex Head Bolt

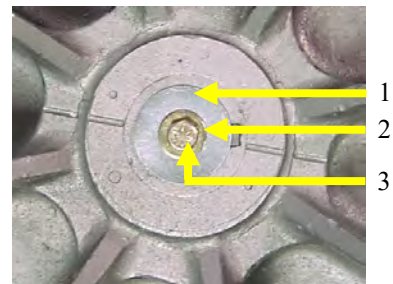

D-1800-FT4
CHASSIS PARTS
(ELECTRIC GROUP)

1. C-1853 Switch

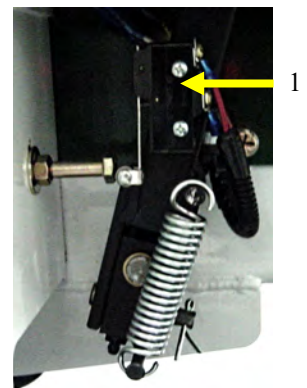

1. H-576 Outer Control Slide
2. H-719 Neutral Switch

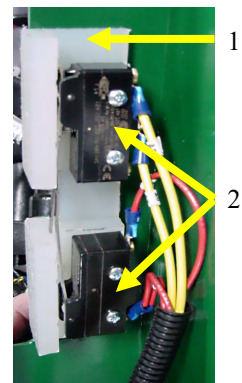

1. C-1803 Back-Up Horn



D-1800-FT4

CHASSIS PARTS

(ELECTRIC GROUP)

1. H-611 Switch Mount Plate
2. H-747 Control Handle (Left Half)
3. H-751 Control Handle (Right Half)

INSET PHOTO

4. D-1243 Switch (Raise/Lower)
5. D-1318 Switch (Attachment On/Off)

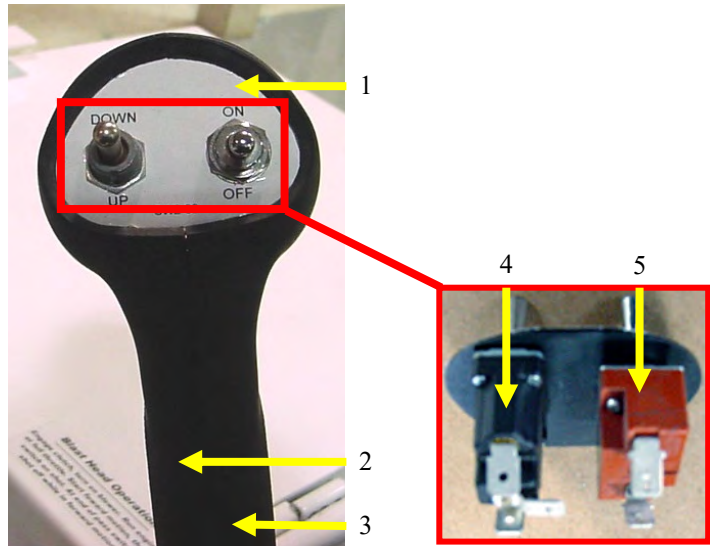

1. C-1718 Safety Switch

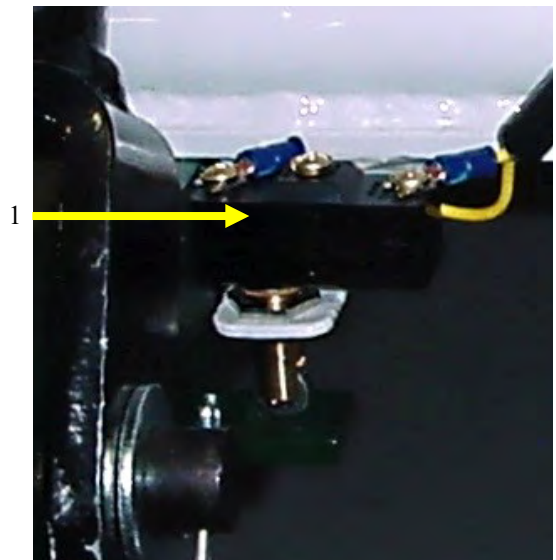

D-1800-FT4
CHASSIS PARTS
(ELECTRIC GROUP)

1. H-624 Chassis Wiring Harness

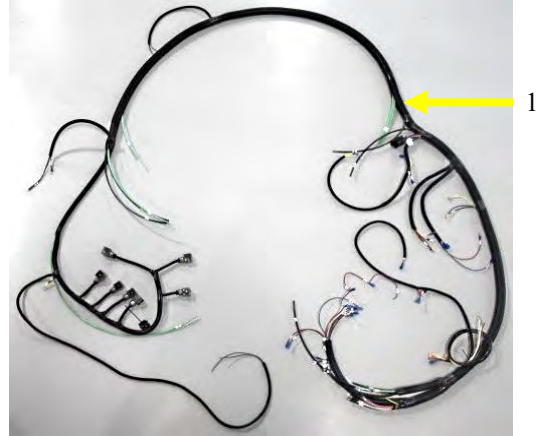

1. H-742 Harness Extension (John Deere) 5 Ft.

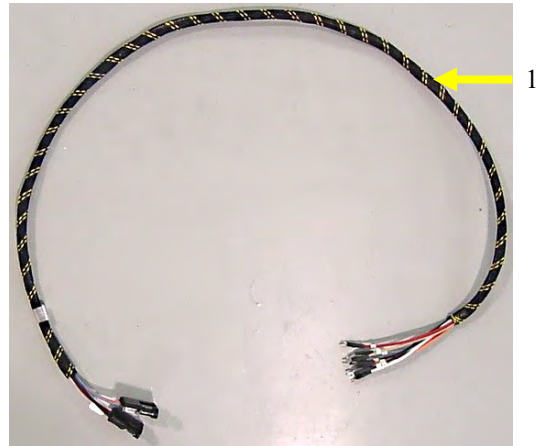

1. H-619 Pulsation Wiring Harness

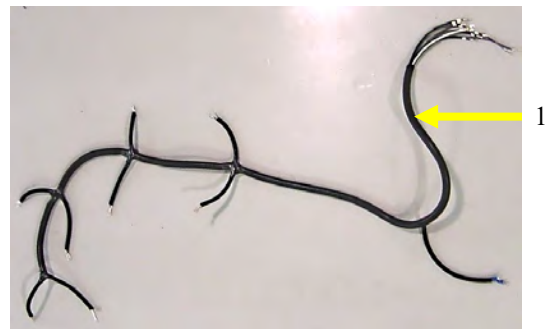

1. H-569 Battery Cable (Positive)
2. H-570 Battery Cable (Negative)

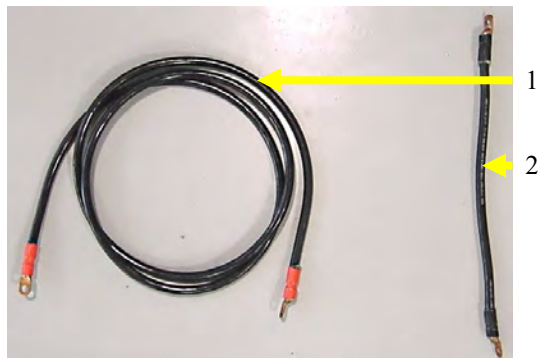

D-1800-FT4 CHASSIS PARTS (AIR GROUP)

Upper Solenoid Valve

1. C-1633 Fitting
2. C-1625 Solenoid Valve
3. W-0007 Brass Nipple
4. V-1049 Coupling
5. V-1031 Fitting (90 Degree)
6. V-1031 Fitting (90 Degree)
7. C-1644 Muffler

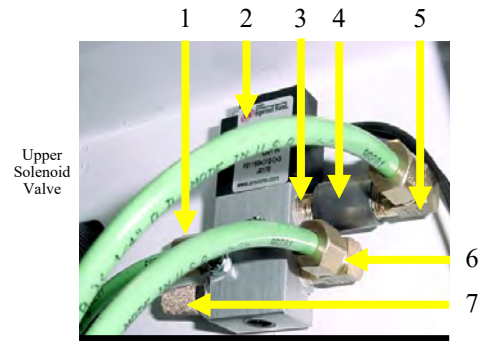

Lower Solenoid Valve

8. I-164 Fitting (T)
9. C-1625 Solenoid Valve
10. E-2107 Plug
11. V-1031 Fitting (90 Degree)
12. C-1644 Muffler

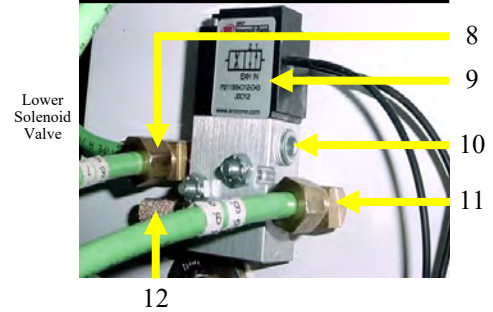

1. 3/8USSF Flat Washer
2. V-1015 Adapter

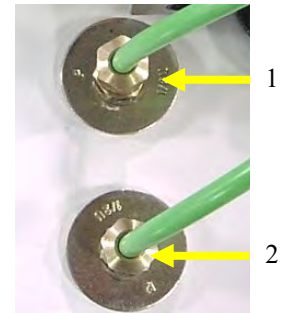

1. C-1630 Quick Connect Air Coupling



D-1800-FT4 CHASSIS PARTS (AIR GROUP)

1. I-182 Pressure Switch
2. D-1231 Adapter
3. C-1917 Adapter
4. C-1935 Compressor to Collector Hose
5. C-1719-T Timer Board
6. C-1660 Timer Board Enclosure

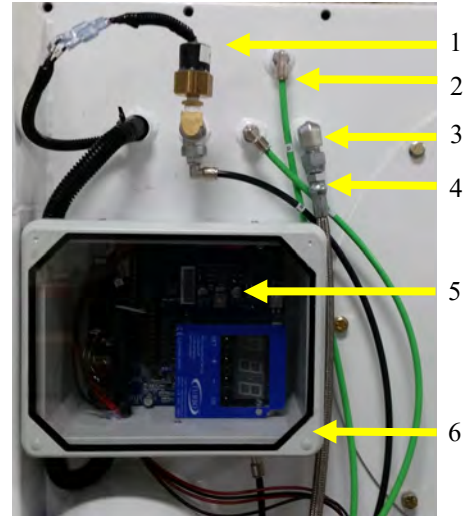

1. I-182 Pressure Switch
2. I-106 Fitting
3. I-117 Coupling Elbow
4. C-1645 Adaptor
5. D-1231 Fitting (90 Degree)

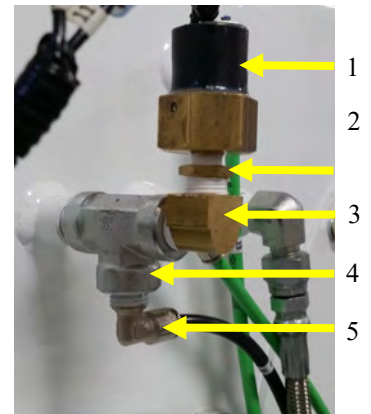

1. Q-1237 Clevis Rod End
2. Q-1213 Air Cylinder
3. V-1031 Fitting (90 Degree)
4. B-1615 Mounting Bracket

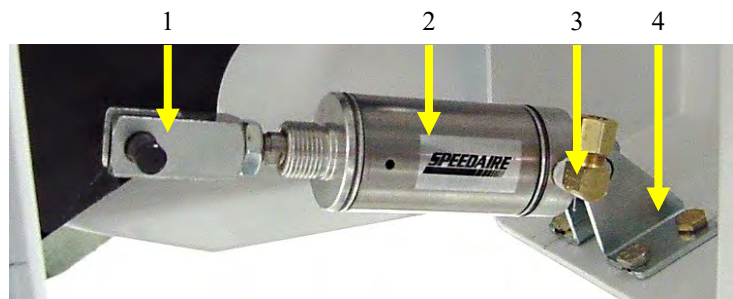

D-1800-FT4 CHASSIS PARTS (AIR GROUP)

1. V-1034-A Filter
2. V-1015 Adapter
3. C-1970 Collector to Air Tank Hose
4. C-1917 Adapter

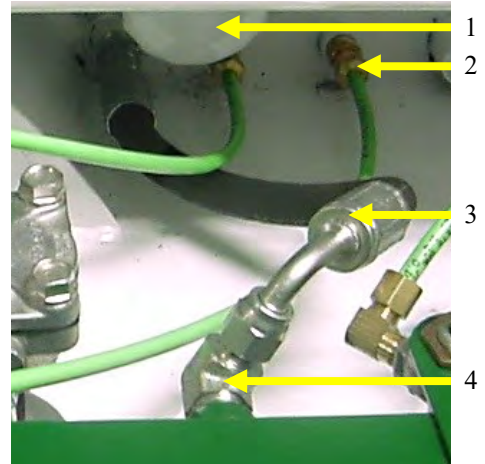

1. H-563-A Air Tank Assembly
2. V-1013 Poppet Valve
3. C-1612-C Coil Pack

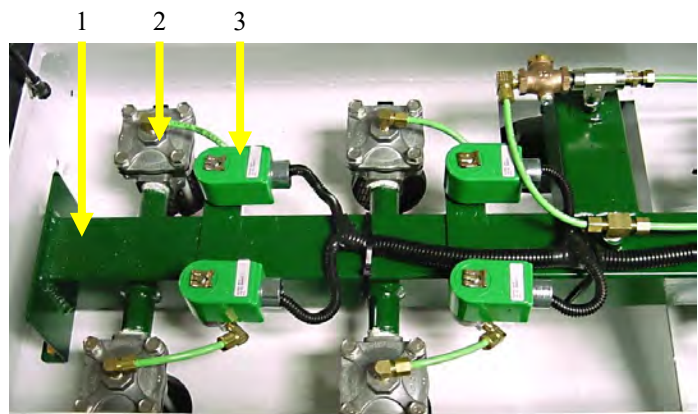

D-1800-FT4 **CHASSIS PARTS** **(AIR GROUP)**

1. V-1031 Poppet Valve
2. V-1031 Fitting (90 Degree)
3. D-1325 Solenoid Valve
4. V-1031 Fitting (90 Degree)
5. V-1019 Adapter

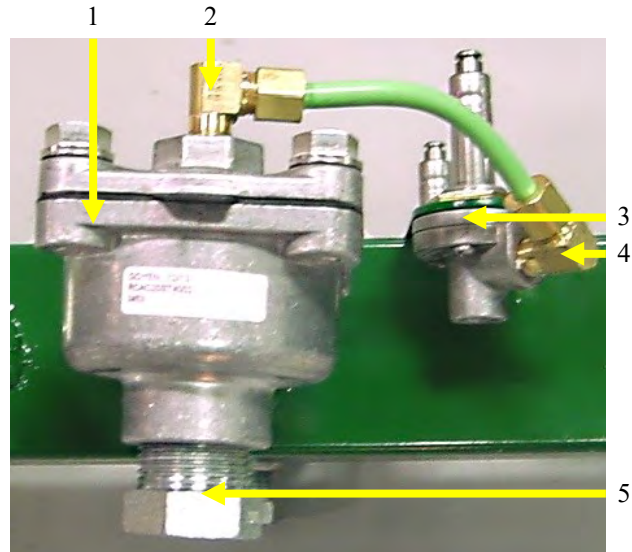

1. V-1015 Adapter
2. C-1645 Adapter (T)
3. V-1039 Pipe Nipple
4. C-1621 Check Valve
5. D-1231 Adapter (90 Degree)
6. C-1623 Pressure Relief Valve

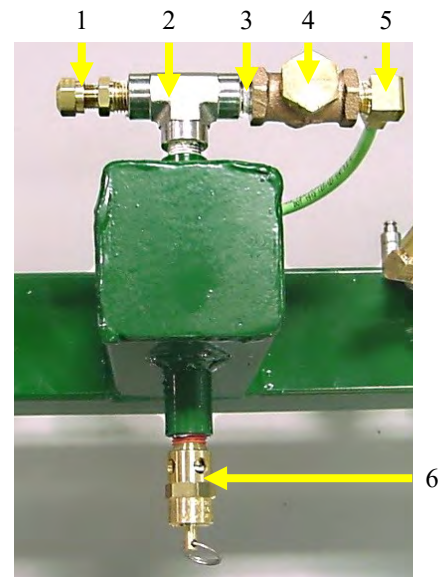

Page
Left
Intentionally
Blank